



**PROPERTY INFORMATION**

- \* Sales Price **\$4-\$8.00/psf**
- \* Appx. 3.14 Acres
- \* Wright County
  - PID 155-157-001010 (1.63 Acre) 2018 Taxes \$7,858.00
  - PID 155-151-004010 (.57 Acre) 2018 Taxes \$3,192.00
  - PID 155-174-001010 (.92 Acre) 2018 Taxes \$5,672.00
  - PID 155-189-001010 (2.99 Acre) 2018 Taxes \$8,710.25
  - PID 155-151-003010 (1.78 Acre) 2018 Taxes \$3,334.00
- \* Zoned: B-4 Business District
- \* Great location for hotels, medical or entertainment!
- \* Businesses in the area include:
  - River City Extreme, Emagine Theater, Taco John's,
  - Premier Bank, Applebee's, Culver's, Walmart, Dollar
  - Tree, Kwik Trip, Aldi's and much more!



**Contact:**  
**WAYNE ELAM**  
**(763) 229-4982**  
**WElam@commrealtysolutions.com**

The information contained herein was obtained from sources believed to be reliable, but Commercial Realty Solutions has not verified nor has any knowledge regarding the accuracy of information and makes no representation or warranty concerning the same. Therefore, Commercial Realty Solutions disclaims all liabilities in connection with any inaccuracies or incompleteness.



COMMERCIAL REALTY SOLUTIONS

# For Sale Commercial Land xxx Deegan Ave., Monticello 55362

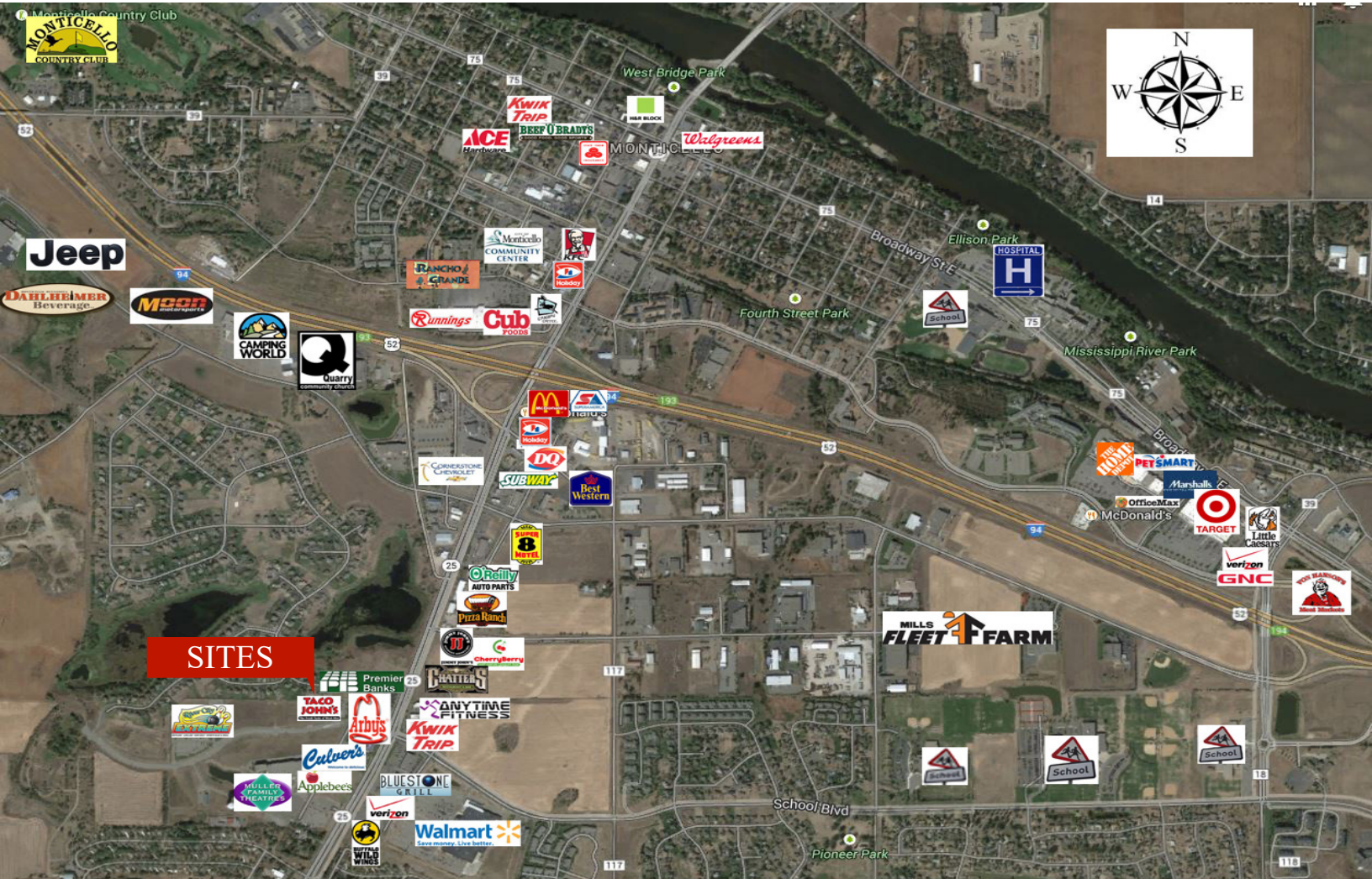

## PROPERTY INFORMATION

- \* Great location for hotels, medical, retail, entertainment, etc.
- \* Located next to River City Extreme and Emagine Theater
- \* Quick and easy access to Highway 25
- \* Minutes from I-94
- \* Many major retailers and services in the area

## TRAFFIC COUNTS - 2017

- \* I-94 - 45,000 VPD
- \* Highway 25 - 30,000 VPD

Contact:

**WAYNE ELAM**  
**(763) 229-4982**

[WElam@commrealtysolutions.com](mailto:WElam@commrealtysolutions.com)



COMMERCIAL REALTY SOLUTIONS

# For Sale Commercial Land xxx Deegan Ave., Monticello 55362

## SITE PLAN



### LOT SIZES

Lot 1, Block 3	77,536.00 sf	1.78 acres
Lot 1, Block 1	70,941.00 sf	1.63 acres
Lot 1, Block 4	24,829.00 sf	0.57 acres
Lot 1, 2nd Addn	40,129.00 sf	0.92 acres
Lot 1, 3rd Addn	130,244.00 sf	2.99 acres

**Contact:**  
**WAYNE ELAM**  
**(763) 229-4982**

[WElam@commrealtysolutions.com](mailto:WElam@commrealtysolutions.com)