

ALL
THE
RIGHT
TOOLS
AUGUST 17-19
1 9 9 5

ASSOCIATION OF CALIFORNIA
SYMPHONY ORCHESTRAS

27TH
ANNUAL CONFERENCE
LOS ANGELES

Hosted by
Los Angeles Chamber Orchestra &
Los Angeles Philharmonic



Ralph Markham
Kenneth Broadway

duo piano

Bartok
Carnival of the Animals
Gershwin
Mozart
Poulenc

*"The new rising stars of
the piano duo."*

— BBC Magazine

*"dazzling...sizzling...
virtuosic."*

— The New York Times



international
212.987.3038 • 212.369.3103 fax

artists group
102053.1051@compuserve.com

WHEN BUILDING A
STRONG ORCHESTRA, AS
IN BUILDING A HOUSE,
A SOLID FOUNDATION IS
EVERYTHING.

At the 27th Annual Conference,
you will find **ALL THE RIGHT TOOLS**
you need to build a strong foundation
for your orchestra. Access the latest
information in the areas of market-
ing, finance, fund raising, and
management — all with a view to
helping you use the right tools for
your job.

WELCOME DELEGATES



Welcome to the City of Angels. The board and staff of the Los Angeles Chamber Orchestra are delighted to join the Los Angeles Philharmonic as hosts of ACSO's 27th Annual Conference. Once again, ACSO has packed a wealth of information into three days of meetings, luncheons, and concerts. I believe there truly is something for everyone, no matter your particular role in your organization. We also have some wonderful artistic experiences in store.

While the Los Angeles area offers a wide variety of fine restaurants, museums, galleries, and performing arts venues, you need go no further than a few blocks from the hotel to experience many of these. So partake as you will from the opportunities that abound and, as you head for home, we trust you will be artistically satiated and filled with ideas for making your next season your best ever.

Carol

Carol D. Ross, president
Los Angeles Chamber Orchestra

Welcome to Los Angeles! The board of directors, staff and musicians of the Los Angeles Philharmonic and Hollywood Bowl join with me in saluting the 1995 ACSO Conference participants. You come to our city during a period of great artistic musical excitement and accomplishment, both in terms of musical performances and new commissions. As each of you knows, the financial challenges facing our orchestras have never been greater. Our arts organizations face an uncertain future of governmental funding, and our traditional sources of support are changing. Because of these dynamics, we are doubling our efforts to preserve support from traditional audiences, as well as developing a new generation of arts enthusiasts. As a Conference participant, you have already demonstrated your commitment to the future of orchestral music. United, we can help our orchestras meet future challenges and continue to inspire, educate and remain central to the cultures of communities.

We wish you an enjoyable stay in Los Angeles and a successful 1995 ACSO Conference.

Bob Attiyeh

Robert S. Attiyeh, president
Los Angeles Philharmonic Association

QUICK LOOK

THURSDAY

AUGUST 17, 1995

- PM Peer Forums
General Session: Successful Community Relationships
ACSO Annual Meeting
Hollywood Bowl

FRIDAY

AUGUST 18, 1995

- AM Leadership Seminar
Nuts and Bolts Roundtables
Do the Right Mix/Telemarketing
Building Blocks to Success
Repertoire Listening Session
Contractors: Artist Management
- PM Jeffrey Kahane, Keynote Lunch Speaker
Bricks and Mortar: The Concert Hall
Apprentice Programs for Education
Books, Balances & New Accounting
Conductor's Forum
General Session: Artistic Vision

SATURDAY

AUGUST 19, 1995

- AM Revolution of Government and Nonprofits
Stewardship 101
Cutting the Job to Size
Skill-Building for Conductors
Managing in Tough Times
Special Event Fund Raisers
Powerful Fund Raising Tools
- PM John Mauceri, Keynote Lunch Speaker
A Foundation for the Future
Precision Tools: Employer/Employee Relations
At Least Ask and Do Tell: Involve Your Musicians
General Session: New Technology for Orchestras
Dinner and LACO Concert

CLASSICAL PERFORMING ARTISTS MANAGEMENT

7758 Ludington Place La Jolla, CA 92037

Constance Mullin, Manager

FAX:(619) 456-1752 TEL:(619) 456-3878

e-mail: 76142.2446@compuserve.com

Talent Agency/Calif. Lic. # TA 1548

NEIL RUTMAN, Pianist

- Winner: Busoni, Casadesus, Joanna Hodges, and Bach Int'l Competitions
- 1st Place Concert Artist Guild
- Orchestral Engagements (partial list)
 - Academy of London
 - Arkansas Symphony
 - Erie Philharmonic
 - Long Beach Symphony
 - Modesto Symphony
 - Peninsula Symphony
 - San Jose Symphony

**Singers for Symphony,
Oratorio, and Pops****Sopranos**

Susan Gundunas
Kerry O'Brien
Melody Rossi
Virginia Sublett
Awilda Verdejo
Sylvia Wen

Mezzo-Sopranos

Elsbeth Franks
Martha Jane Weaver

Tenors

Matthew Bitetti
Bruce Johnson

Baritones

Dale Morehouse
Douglas Nagel

Bass

Peter Klaveness

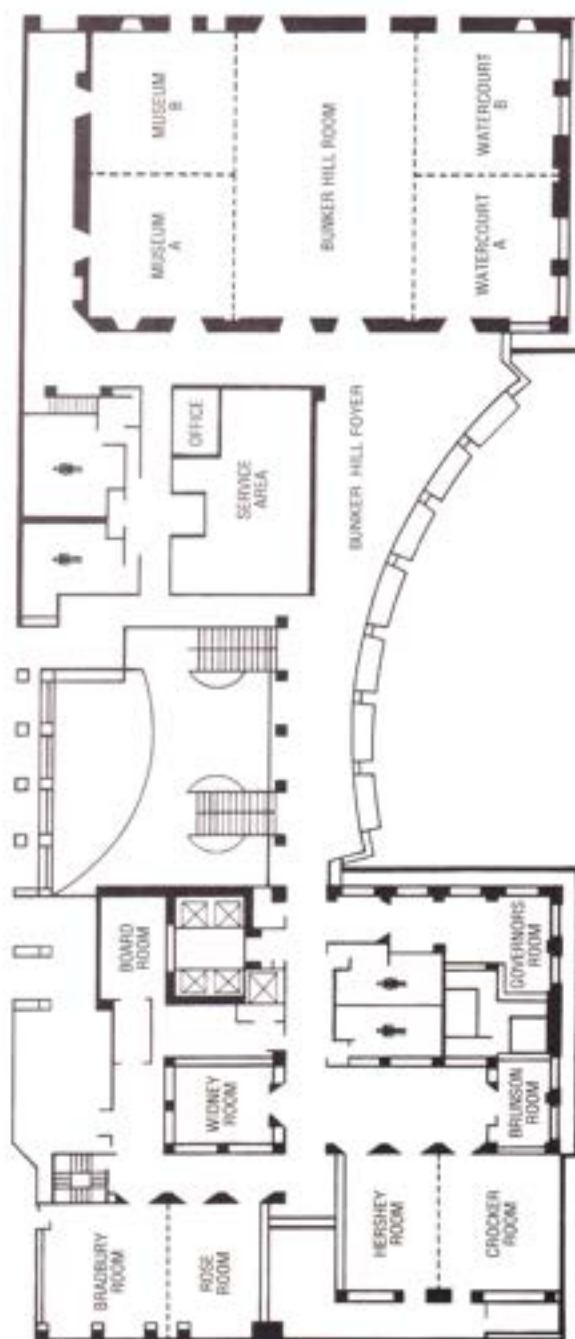

HOTEL
INTER-CONTINENTAL

SECOND FLOOR

CONFERENCE NOTES

Conference Committee

Patricia Gessner (Conference Chairman),
Trudi Benford, Tim Beswick, Sharon C. McNalley,
Christopher Minnes, Mike Morris, Lynn Osmond,
Asher Raboy, Bruce Thibodeau

Orchestra Boutique

Phyllis Apfel, Amy Carson-Dwyer

On-Site Coordinators

Trudi Benford, Jennifer Pimbley

Volunteer Coordinators

Trudi Benford, Shirley Davis, Leigh Trenham

Many thanks to the members of the ACSO Conference Committee, the ACSO board of directors, the staffs and volunteers of the host orchestras and those of you who contributed to this Conference with your time and expertise.

CONFERENCE REGISTRATION AND TICKETS

Bunker Hill Foyer

Hours:

Wednesday, August 16	5:00 PM - 8:00 PM
Thursday, August 17	9:00 AM - 12:00 PM 2:00 PM - 3:00 PM
Friday, August 18	8:00 AM - 10:00 AM
Saturday, August 19	8:00 AM - 10:00 AM

Conference registration and special event tickets can be paid for by cash, check, VISA or MasterCard. Make checks payable to ACSO. Tickets for meals or concerts cannot be exchanged or refunded.

RESOURCE ROOM

Watercourt

Orchestra Brochures • Artist Manager Brochures and Rosters •
Computer Information • Scores and Tapes • Orchestra Boutique •
Software Demonstrations

PLEASE WEAR YOUR NAME
BADGE AT ALL TIMES

SPECIAL THANKS

Special thanks to the following friends of ACSO who have provided in-kind services or merchandise during the year or for the Annual Conference:

Essary Dal Porto & Lowe, Certified Public Accountants
E & J Gallo Winery
Korbel Champagne Cellars, courtesy of the Santa Rosa Symphony
Museum of Contemporary Art, Los Angeles
San Francisco Symphony
SuperShuttle Los Angeles

Goodie Bag donors:

A to Z You Name It
Beecher Laboratories
Chris Crosson
Disney Feature Animators
Hoag Hospital
Jenny Craig Weight Loss Centers, Inc.
Kemper Securities
LA Convention and Visitors Bureau
Los Angeles Chamber Orchestra
Master Design
Nabisco
See's Candies
Southwest Airlines

Thank you to the many organizations who have donated clever and interesting items to the ACSO Boutique.

SHOP AT THE ORCHESTRA BOUTIQUE

Watercourt

All proceeds benefit the
Association of California Symphony Orchestras

The Association of California Symphony Orchestras is supported in part by a grant from the California Arts Council.

Since 1961,
Young Concert Artists has been
discovering extraordinary musicians
like Emanuel Ax, Murray Perahia,
Pinchas Zukerman, Dawn Upshaw,
Carter Brey & Juliette Kang.

1996-97 Roster:

Piano: Fazil Say, Graham Scott,
Mikhail Yanovitsky

Violin: Dmitri Berlinsky, Scott Yoo

Viola: Nokuthula Ngwenyama

Clarinet: Todd Palmer

Oboe: Diana Doherty

Baritone: Christòpheren Nomura

Soprano: Kyoko Saito

Cello: Alban Gerhardt, Jan-Erik Gustafsson

Marimba: Makoto Nakura

Composer-in-Residence: Dan Coleman



It's our 35th anniversary.

Call us today!

Cathy P. Monseur
Artist Manager

YOUNG CONCERT ARTISTS, INC., a non-profit management
Susan Wadsworth, Founder & Director

250 West 57 Street Suite 1222 New York, New York 10019
Telephone: (212) 307-6655 Fax: (212) 581-8894

*"Young Concert Artists' track record for spotting the best
new talent in classical music is legendary." - THE NEW YORK TIMES*

Del Rosenfield Associates

PIANISTS

Bruce Brubaker
Babette Hierholzer
Masanobu Ikemiya
Mina Miller
Míceál O'Rourke
Rita Sloan

INSTRUMENTALISTS

Margaret Batjer, violin
Paul Fried, flute
Nancy Green, cello
Steven Honigberg, cello
Chin Kim, violin

CONDUCTORS

Gisèle Ben-Dor
Eduardo Östergren
Walter Proost

714 Ladd Road, Riverdale, NY 10471
(718) 549-5687 Fax (718) 548-4313

HERBERT BARRETT MANAGEMENT

1996-1997 SEASON

HERBERT BARRETT, PRESIDENT,

NANCY WELLMAN, VICE-PRESIDENT, JOHN A. ANDERSON, VICE PRESIDENT

CONDUCTORS

DAVID CHARLES ABELL
ROBERT BERNHARDT
LEIF BJALAND

RICHARD BUCKLEY

*EMIL DE COU

HERBERT BARRETT MANAGEMENT
CONGRATULATES MO. DE COU
ON HIS NEW APPOINTMENT AS
PRINCIPAL POPS CONDUCTOR OF
THE SAN FRANCISCO SYMPHONY

*FRANZ-PAUL DECKER

ENRIQUE ARTURO DIEMECKE

JONATHAN DUDLEY

ENRIQUE GARCIA-ASENSIO

JOHN GIORDANO

JOSEPH GIUNTA

RAYMOND HARVEY

LOUIS LANE

STEPHEN LORD

MITCH MILLER

ROGER NIERENBERG

BERNARD RUBENSTEIN

KENNETH SCHERMERHORN

JAMES SEDARES

JAMES SETAPEN

ALESSANDRO SICILIANI

KATE TAMARKIN

SIR MICHAEL TIPPETT

EVAN WHALLON

PIANISTS

LYDIA ARTYMIW

EDMUND BATTERSBY

PHILIPPE BIANCONI

*SERGEI EDELMANN

DAVID GOLUB

GARY GRAFFMAN

JEROME LOWENTHAL

BENEDETTO LUPO

PANAYIS LYRAS

ANNE-MARIE MCDERMOTT

SUSAN STARR

EARL WILD

VIOLINISTS

PIERRE AMOYAL

TOSHIYA ETO

*VADIM GLUZMAN

MARK KAPLAN

ANI KAVAFIAN

IDA KAVAFIAN

BENNY KIM

ISABELLA LIPPI

DANIEL PHILLIPS

VIOLIST

KIM KASHKASHIAN

CELLISTS

COLIN CARR

ANDRÉS DÍAZ

ZARA NELSOVA

*DAVID SOYER

FLUTIST

MARINA PICCININI

TRUMPET

JOHN WALLACE

FRENCH HORN

DAVID JOLLEY

SOPRANOS

MARGARET CUSACK

CONSTANCE FEE

*FRANCES GINZER

RUTH GOLDEN

*APRIL-JOY CUTIERREZ

CONSTANCE HAUMAN

ELIZABETH HOLLEQUE

LINDA KELM

JOSLYN KING

*LINDA MABBS

ERIE MILLS

MARILYN MIMS

*KELLEY NASSIEF

LAURINDA NIKKEL

STEFFANIE PEARCE

ROSTER OF DISTINGUISHED ARTISTS

SOPRANOS (continued)

CARMEN PELTON

CHRISTINE SEITZ

JEANINE THAMES

KORLISS UECKER

ANNALISA WINBERG

MEZZO-SOPRANOS

CHRISTINE ABRAHAM

*ELIZABETH BISHOP

JOSEPHA GAYER

THEODORA HANSLOWE

VICTORIA LIVENGOD

ROBYNNE REDMON

MARIETTA SIMPSON

CONTRALTOS

METTE EJSING

ELLEN RABINER

TENORS

JOHN ALER

*DONALD BRASWELL

JOHN DANIECKI

*DENG

VLADIMIR GRISHKO

DONALD KAASCH

PAUL AUSTIN KELLY

GARY LAKES

MARK REHNSTROM

GLENN SIEBERT

BARITONES

SHERRILL MILNES

VICTOR LEDBETTER

PETER LIGHTFOOT

DANIEL MOBBS

MARK OSWALD

WILLIAM SHARP

THOMAS WOODMAN

BASS-BARITONES

KELLY ANDERSON

RICHARD COWAN

KENNETH SHAW

JOHN SHIRLEY-QUIRK

PETER STRUMMER

ANDREW WENTZEL

BASSES

MARK FREIMAN

*DONG-JIAN GONG

BRIAN JAUHAINEN

KEVIN MAYNOR

NARRATOR

WERNER KLEMPERER

SPECIAL ATTRACTIONS FOR ORCHESTRA

CHANTICLEER

GOLUB-KAPLAN-CARR TRIO

MAGIC CIRCLE MIMIC

GUARNERI STRING QUARTET

BILLY TAYLOR TRIO

ANI AND IDA KAVAFIAN

CORKY SIEGEL

(SYMPHONIC BLUES)

*DANIEL AND TODD PHILLIPS

* FIRST SEASON WITH
HERBERT BARRETT MANAGEMENT

* TODD PHILLIPS IS MANAGED BY
SHUFF ARTISTS MGMT.

NAPAMA MEMBER

DESIGN: BICK GRIFFITH DESIGN, NY

VISIT ROB ROBBINS
@ THE ACSO COFERENCE

1776 BROADWAY, SUITE 1610, NY, NY 10019

PHONE 212.245.3530; FAX 212.397.5860

1994-95 CONTRIBUTORS

The Association of California Symphony Orchestras gratefully acknowledges the support of its many good friends whose contributions help ACSO to continue its service to the orchestra community.

MAJOR GIFTS

BankAmerica Foundation
California Arts Council
The Ann and Gordon Getty Foundation
The Clarence E. Heller Foundation
The William and Flora Hewlett Foundation
The James Irvine Foundation
The David and Lucile Packard Foundation
Dr. Sylvia Shepherd
Yamaha Corporation of America

CONFERENCE SPONSORS

ASCAP
Artsmarketing Services Inc.
Columbia Artists Management, Inc.
Stephen Dunn & Associates
First Interstate Bank
ICM Artists Ltd.
IMG Artists
Janice M. Johnson
MSGI/MetroArts
The law firm of Musick, Peeler & Garrett
Young Concert Artists

GIFTS \$300 AND ABOVE

Peggy E. Duly	Mainly Mozart Festival
Sakurako Fisher	San Francisco Symphony
Neal Hefti	Beverly Hills
Sharon C. McNailey	Orange County Philharmonic Society
Stephen (Mike) Morris	Pasadena Symphony
Louis G. Spisto	Pacific Symphony Orchestra

GIFTS \$150 - \$299

Phyllis Apfel	Santa Rosa Symphony
Mike Bates	Yamaha Corporation of America
Karine Beesley	The John Anson Ford Theatre Foundation
Tim Beswick	San Jose Symphony
Corrick Brown	Santa Rosa Symphony
Barbara Burger	Santa Barbara Symphony
Amy Carson-Dwyer	Colbert Artists Management
Jennifer Diener	Los Angeles Chamber Orchestra

Christina Diver
Pauline Fisher
Patricia Gessner
Karney Hodge
Mark Jordan
Mitchell Sardou Klein
Lawrence Kohl
Diane Lent
Christopher Minnes
Irene Klug Nielsen
Helen Cirello Norton
Lynn Osmond
Jo Ellen Qualls
Asher Raboy
Pamela Taylor
Joseph Truskot
Ann Vander Ende

Interlochen Center for the Arts
Santa Rosa Symphony
San Francisco Symphony
Sacramento
Modesto Symphony
Peninsula Symphony North
The Classical Philharmonic
Modesto Symphony
Long Beach Symphony
Fresno Philharmonic
Alzheimer's Association
Sacramento Symphony
Pacific Symphony Orchestra
Napa Valley Symphony
Santa Barbara Chamber Orchestra
Monterey County Symphony
Philharmonia Baroque Orchestra

GIFTS \$60 - \$149

Suzanne Allen	Modesto Symphony
Thomas Amory	Santa Barbara Chamber Orchestra
Leni Isaacs Boorstin	Los Angeles Philharmonic
Boris Brott	Ventura County Symphony
Richard D. Colburn	Los Angeles Philharmonic
Stewart Comer	Music From Bear Valley
Richard Dugan	Diablo Symphony
JoAnn Falletta	Long Beach Symphony
Nellie Fay	Napa Valley Symphony
Ernest Fleischmann	Los Angeles Philharmonic
Rhoda H. Goldman	San Francisco Symphony
Bram Goldsmith	Los Angeles Philharmonic
John Hancock	Long Beach Symphony
Cricket Handler	San Luis Obispo
Jean Harrison	Santa Rosa Symphony
Laura Hemenway	Antelope Valley Symphony
Evelyn Hill	Inland Empire Symphony
Catherine Isett	Rohnert Park Chamber Orchestra
Janice M. Johnson	Pacific Symphony Orchestra
Jeffrey Kahane	Santa Rosa Symphony
Karen Kimes	Ford Centre for Performing Arts
Phyllis Kraus	San Diego Symphony
Jane Lawson	Orange County Philharmonic Society
Shirley Lewis	San Jose Symphony
Ronald Marks	Sierra Symphony Orchestra
Sherrie McCullough	Monterey County Symphony
James T. Medvitz	Pacific Symphony Orchestra
Carole S. Miller	Pacific Symphony Orchestra
Millie Mitchell	California Symphony
Diane Moore	Pacific Symphony Orchestra
Ellen Moore	Modesto Symphony Guild
Mary E. Newkirk	Long Beach Symphony
Peter Pastreich	San Francisco Symphony
Neale Perl	La Jolla Chamber Music Society

Peggy Peterson
Thomas W. Petrovich
Frank J. Plash
George Ramirez
Ben Reddish
Alan Remington
Irving Root, M.D.
Donald M. Ross
Nancy Schneider
Mary Schnepf
Edwin A. Seipp, Jr.
Sunny Simons
George A. Sinclair
Gang Situ
David Smythe
Jean Squair
Kathie Svoboda
Linda L. Temple
Bruce D. Thibodeau
Suzanne Turbeville
Jeannine Wagner
Gerald G. Willis
James L. Wright

San Luis Obispo County Symphony
Ventura County Symphony
Inland Empire Symphony
Stockton Symphony
Stockton Symphony
Orange Coast College Orchestra
Inland Empire Symphony
Antelope Valley Symphony
Stockton Symphony
Inland Empire Symphony Guild
San Francisco Symphony
Santa Cruz County Symphony League
Stockton Symphony
Chinese Cultural Productions
Sierra Symphony Orchestra
Assn. Calif. Symphony Orchestras
Redding Symphony
Rohnert Park Chamber Orchestra
Los Angeles Chamber Orchestra
Masterworks Chorale
Santa Clarita Symphony
North Lake Tahoe Symphony
Santa Barbara Symphony

GIFTS \$46 - \$59

Nancy H. Bechtie
Paul Bonaccorsi
Richard Corbett
Suzanne M. Dewar
Donald R. Dickey
Christopher Fazzi
Bettye P. Ferguson
Yehuda Gilad
Michael Goodwin
Frances Grover
Rondell Hanson
Peg Irish
Judith Jelinek
Bernard Karian
Karen Keltner
Louis F. Kendall
Donald Lafler
Mike Lewis
David Marsten
Sheila Ostrow
Jean M. Reed
Elise Unruh
William R. Williams

San Francisco Symphony
Fremont Symphony
Santa Rosa Symphony
Assn. Calif. Symphony Orchestras
Marin Symphony
Glendale Youth Orchestra
San Francisco Symphony
Malibu Music Festival Orchestra
Renaissance Orchestra & Chorus
Long Beach Symphony
Pacific Symphony Orchestra
Stockton Symphony
OCPS Committees
Fresno Philharmonic
San Diego Opera
Santa Rosa Symphony
Santa Barbara Chamber Orchestra
Stockton Symphony
Santa Rosa Symphony
Santa Monica Symphony
Santa Rosa Symphony League
Santa Barbara Civic Light Opera
Santa Rosa Sym. Discovery/Prep Orchestra

Please join or renew your membership at Conference. Individual membership is \$45. Membership in ACSO is one year from October 1 to September 30.

WEDNESDAY
August 16
1995

Bunker Hill Foyer
5:00 PM - 8:00 PM **Registration**

THURSDAY
August 17
1995

Governor's Room
10:00 AM - 12:30 PM **ACSO Board Meeting**

12:30 PM - 1:00 PM **ACSO Board Orientation**

Bunker Hill Foyer
9:00 AM - 12:00 PM **Registration**

2:00 PM - 3:00 PM **Registration**

1:00 PM - 2:30 PM

Museum A & B

■ Peer Forums

An opportunity to learn and share tips of the trade, this session is a must for managers, conductors, board and staff of like-budget organizations. Held in two rooms.

Coordinator: Michael Royer, general manager, Modesto Symphony

Tables 1 - 7 meet in Museum A & B

- | | |
|---------|--|
| Table 1 | Managers/Orchestras with budgets less than \$100,000
<i>Cathy Stapert, executive director, Santa Barbara Chamber Orchestra</i> |
| Table 2 | Managers/Orchestras with budgets of \$100,000-\$250,000
<i>Susan Stamberger, executive director, Los Angeles Mozart</i> |
| Table 3 | Managers/Orchestras with budgets of \$250,000-\$500,000
<i>James Ruggirello, executive director, Japan America Symphony</i> |
| Table 4 | Managers/Orchestras with budgets of \$500,000-\$1,000,000
<i>Millie Mitchell, general manager, California Symphony</i> |
| Table 5 | Managers/Orchestras with budgets over \$1,000,000
<i>Mary E. Newkirk, executive director, Long Beach Symphony</i> |
| Table 6 | Managers/Trustees of Youth Orchestras
<i>Cynthia Weichel, manager, Santa Rosa Youth Orchestras</i> |
| Table 7 | Conductors
<i>Asher Raboy, music director, Napa Valley Symphony</i> |

Tables 8 - 14 meet in Hershey/Crocker

- Table 8 **Development Directors**
Tom Carlo, development director, Pacific Symphony Orchestra
- Table 9 **Marketing/Public Relations Directors**
Sara Obuchowski, marketing director, Santa Rosa Symphony
- Table 10 **Operations/Assistant Managers**
Carol Handelman, director of operations & finance, Philharmonia Baroque Orchestra
- The following peer designations will have round tables available without a facilitator. We encourage you to gather and share among yourselves:
- Table 11 **Education Directors and Education Volunteers**
- Table 12 **Managers/Trustees of Colleges & University Orchestras**
- Table 13 **Finance Directors**
- Table 14 **Volunteers of Leagues & Guilds**



JAMES DICK

pianist

Orchestral and Recital Inquiries
please contact:

Alain Declert & Associates
P. O. Drawer 89
Round Top, Texas 78954, USA
(409) 249-3086 FAX (409) 249-3100

3:45 PM - 5:00 PM

Bunker Hill

OPENING GENERAL SESSION

■ **A Toolbox of Ideas:
Building Successful Community Partnerships**

Fitting into your community is not just programming one concert for a culturally specific group. It requires delicate assembly, numerous tools and collaboration between board and staff. California orchestras have developed compelling programs, becoming "inclusive" in their communities and addressing the very real and important demographic changes occurring in our state. Our panel, teams of two, will provide a blueprint for achieving the goal of making our orchestras' programs accessible and viable in our communities.

Moderator: *Patricia Gessner, director of marketing, San Francisco Symphony*

Teams: *Dan Miller, program associate, The James Irvine Foundation and Louis G. Spilto, executive director, Pacific Symphony Orchestra*

Curtis Owens, executive director, African American Unity Center and Bruce D. Thibodeau, executive director, Los Angeles Chamber Orchestra

Hyojook Park, music director, Korean Master Chorale and Leni Isaacs Boorstin, public affairs director, Los Angeles Philharmonic

Leonard Valdez, director, California State University, Sacramento Multi-Cultural Center and Nan Washburn, music director, Camellia Orchestra and Rohnert Park Chamber Orchestra

4:30 PM - 5:45 PM

Crocker

■ **ACSO Annual Meeting**

Invited guest: Alan Chapman. Mr. Chapman is a well-known pre-concert lecturer and the broadcast voice of the Los Angeles Chamber Orchestra

6:00 PM - 6:15 PM

Meet in front of hotel to board buses to Bowl

7:30 PM

Picnic Supper

8:30 PM

Hollywood Bowl Concert
Los Angeles Philharmonic, Peter Maag, conductor

10:30 PM

Post-Concert Reception on the Deck, Hollywood Bowl
Hosted by Los Angeles Chamber Orchestra and Los Angeles Philharmonic



ARTIST ROSTER

conductor

Lukas Foss
Justus Frantz
Derrick Inouye
Stephen Rogers
Radcliffe

piano

Alain Lefèvre
Nikolai Lugansky
Ralph Markham &
Kenneth Broadway

orchestra pops

John Bayless, *piano*
Evans Haile, *conductor*

composer

Joanna Bruzdowicz
Alexander Knaifel
Keith Pruitt

timothy sean bickerton

thomas j. hudock

director

associate

FRIDAY
AUGUST 18
1995

Bunker Hill Foyer
8:00 AM - 10:00 AM Registration

PERSONAL DEVELOPMENT SEMINAR

8:30 AM - 12:30 PM
Bradbury

Working with People Is a Basic Tool

Any job demands that we communicate effectively with many different personality types. Attend this Seminar and learn how your personality preferences are a good fit or a misfit. Learn how to listen for cues that signal the other person's preference and how to respond effectively.

Barbara Pollack, Ph.D., is a clinical/consulting psychologist specializing in leadership development and coaching, team development and conflict resolution.



- The \$55 cost of this seminar, for admission, materials, coffee and croissants, is in addition to the regular Conference registration.

9:00 AM - 10:30 AM

Bunker Hill

■ Nuts and Bolts

(a.k.a. Innovative Case Studies)

Change tables twice — listen to creative ideas with practical solutions.

Coordinator: **Barbara Burger**, marketing director,
Santa Barbara Symphony

Table 1

**Arts Administration -
A Resource for the Field**
Christopher Minnes, development director,
Long Beach Symphony;
Trudi Benford, marketing director,
Los Angeles Chamber Orchestra;
Eddi Wolk, Orange County Performing Arts Center

Table 2

The Historical Record Keepers of the Flame
Orrin Howard, archivist,
Los Angeles Philharmonic

Table 3

If the IRS Calls, Will Your Documents be in Order?
Martin Bella-Berger, CPA, vice president,
Block, Plant & Eisner

- Table 4 **On-line and Loving It,**
Diane Moore, finance director,
Pacific Symphony Orchestra;
Chris Rouk, account executive, *Pacific Blue Micro*;
Todd Rowe, network engineer, *Pacific Blue Micro*
- Table 5 **Playing in the Elements - Outdoor Concerts**
Craig Hadjuk, general manager,
San Diego Symphony;
James Wright, general manager,
Santa Barbara Symphony
- Table 6 **Good Market Research Reveals All**
George Boomer, president, *Boomer Enterprises*,
senior consulting partner,
Technology Application Group
- Table 7 **New Connections - Concerts Downtown**
Karin Furuta, community and education
programs manager, *Los Angeles Philharmonic*
- Table 8 **What Could an ACSO Consultant Do
For Your Organization?**
Karine Beesley, chair, *Consultation Program*;
director, *The John Anson Ford Theatre Foundation*

10:45 AM - 12:00 PM

CONCURRENT SESSIONS

Museum A

■ Do the Right Mix

This session explores the relationship between direct mail and telemarketing, and how these powerful tools can maximize your sales results. Learn who you should be mailing to as well as the type of telemarketing campaign that is best suited for your orchestra.

- Moderator: *John MacElwee*, marketing director,
Pacific Symphony Orchestra
- Panelists: *Rob Brown*, president, *Artsmarketing Services Inc.*
Tom Holm, director of client services,
Enertex Marketing, Inc.

This session is sponsored by Artsmarketing
Services Inc.

Museum B

■ Building Blocks to Success

The most important way to build self-esteem in your volunteers is to ensure successful activities. A showcase of proven, cost-effective techniques that motivate volunteers, raise money and sell tickets.

- Speaker: *Joseph Truskot*, executive director,
Monterey County Symphony

Hershey

■ Repertoire Listening Session

This popular session opens the musical toolbox to showcase accessible compositions by African-American composers.

- Speaker: *Hansonia Caldwell*, professor of music,
California State University, Dominguez Hills;
board member, *Los Angeles Philharmonic*

Crocker

■ Dealing with Contractors and Sub-Contractors: The Art of Artist Management

This panel takes a fresh look at how to foster creativity between artist managers and orchestra administrators. Learn how valuable an artist manager can be as an artistic resource. Find out how managements select an artist, how a new artist is presented to the orchestra market, and how good relationships are needed to nurture both the future of the orchestra and the artists of tomorrow.

- Moderator: *Amy Carson-Dwyer*, artist manager,
Colbert Artists Management
- Panelists: *Connie Mullin*, artist manager,
Classical Performing Artists
Rob Robbins, western states representative,
Herbert Barrett Management, Inc.
Kenneth Wentworth, president,
Jonathan Wentworth Associates, Ltd.

12:30 PM - 2:00 PM

Bunker Hill

Luncheon



Keynote Speaker:
Jeffrey Kahane,
pianist, music director,
Santa Rosa Symphony

"Where Do We Go From Here?"

Sponsored by IMG Artists in
honor of the appointment of
Mr. Kahane as music director
of the Santa Rosa Symphony

2:15 PM - 3:30 PM

CONCURRENT SESSIONS

Bradbury

■ **Bricks and Mortar:**

When to Send in the Wrecking Ball

The acoustic and comfort of your concert hall can make or break your orchestra's performance. How does an orchestra energize the physical facility to put its best foot forward in the community? Sometimes there are low-cost improvements than can dramatically improve the hall, and sometimes a building should be destroyed and rebuilt.

Moderator: **Karney Hodge**, past president, ACO and ASOL; vice president, public finance, Smith Barney

Panelists: **Vicki Dickerson**, construction director, Sundance Management
Polly Fisher, executive director, Santa Rosa Symphony
Christopher Jaffe, Jaffe Holden Scarbrough Acoustics, Inc.
John Tofoli, general manager, Concord Pavilion

Museum A

■ **Books, Balances and the New Accounting Format**

Want to learn more about the new accounting and contributed income reporting rules and regulations for orchestras? What is Unrelated Business Income Tax (UBIT) and how does it affect orchestras? These hot topics affect marketing, development and finance departments every day.

Moderator: **Bruce D. Thibodeau**, executive director, Los Angeles Chamber Orchestra

Panelists: **Larry Hudspeth**, chief financial officer, Center Theater Group
William D. Jacobs, audit senior manager, Ernst & Young

Museum B

■ **Creating Apprentice Programs**

If the goal of orchestra education programs is "building the audience of the future," who is looking after the young audience of the present? Hear how orchestras large and small are addressing contemporary interests and concerns, and how young people are being involved in the symphonic experience in new and creative ways.

Moderator: **James Ruggirello**, executive director, Japan America Symphony; education consultant, Los Angeles Philharmonic

Panelists: **Janet Bajza**, performing arts special events coordinator, Long Beach Unified School District
Cynthia Ellis, musician, Pacific Symphony Orchestra
Michael Pastreich, concerts manager, San Jose Symphony

Rose

■ **Conductor's Forum:**

Cost Overruns and Other Challenges

Two conductors speak out on the artistic challenges they faced when their orchestras had financial difficulties.

Host: **Mitchell Sardou Klein**, music director, Peninsula Symphony North

Speakers: **Michael Morgan**, music director, Oakland East Bay Symphony
Ransom Wilson, music director, San Francisco Chamber Symphony

4:00 PM - 5:00 PM

GENERAL SESSION

Bunker Hill

■ **Programming Artistic Vision:
Toward a New Orchestral Repertoire**

Chairman: **Ernest Fleischmann**, executive vice president and managing director, Los Angeles Philharmonic

Panelists: **Hanson Caldwell**, professor of music, California State University, Dominguez Hills; board member, Los Angeles Philharmonic
Jeffrey Kahane, pianist; music director, Santa Rosa Symphony
William Kraft, composer; director of music department, University of California Santa Barbara
Daniel Rothmuller, associate principal cello, Los Angeles Philharmonic

This session is sponsored by MSG/Metro Arts

6:00 PM - 7:30 PM

■ **President's Reception for ACO Donors**
by Invitation

Sponsored by First Interstate Bank, the law firm of Musick, Peeler & Garrett and Stephen Dunn & Associates

8:00 PM **Miss Saigon**, Ahmanson Theatre
The Music Center
135 N. Grand Avenue

SATURDAY
AUGUST 19
1995

Bunker Hill Foyer
8:00 AM - 10:00 AM Registration

NEW SESSION

7:45 AM - 8:30 AM

Museum A

■ Forget (Most of) What You Learned in School: No One Will Escape this Revolution

The ascendancy of Newt and Company is not just a flash in the pan — this change is likely to last for a while, and we've only seen the beginning. The arguments even just two years ago about public funding for the arts seem quaint now; the entire ground of debate is changing, not only for the arts, but for all nonprofits. Hear how government's view of nonprofits is changing — and how orchestras may be changed because of it.

Speaker: **John Sparks**, director of government affairs,
American Symphony Orchestra League

9:00 AM - 10:30 AM

Museum A

■ Ax or Paring Knife? Cutting the Job Down to Size

As hard as it is to do, we sometimes have to let a concert go or give up a special program that has been well-loved in the community. How do we determine what to do? How do we balance the dollar savings against the good will of our musicians and communities? Hear a cautionary tale about the realities of right-sizing.

Moderator: **Irene Klug Nielsen**, executive director,
Fresno Philharmonic

Speakers: **Michael Chappell**, board member, Fresno Philharmonic
Lynn Osmond, executive director, Sacramento Symphony
Carol Ross, president, Los Angeles Chamber Orchestra

Museum B

■ Stewardship 101: Building a Board of Directors

A saw without its blade... a hammer without nails... a board without members? Recruitment is possibly the most essential ongoing activity for any board, and one of the most overlooked. Learn to qualify and recruit the right person in the context of your orchestra's operations.

Moderator: **Mike Morris**, past president, Pasadena Symphony

Speakers: **Tina Diver**, board member, Interlochen Center for the Arts; San Francisco Conservatory of Music
Patrick Whaley, partner, the law firm of Musick, Peeler & Garrett; trustee, Getty Museum

SATURDAY AUGUST 19 1995

Crocker

■ Skill-Building for Conductors

Practical advice on the challenges of being a music director in the '90s from one of the country's most respected conductors and teachers.

Speaker: **Daniel Lewis**, retired director of orchestral and conducting studies, USC, former music director, Pasadena Symphony

10:45 AM - 12:00 PM

Crocker

■ Managing in Tough Times

Close the door and the problems come in the windows. A respected manager discusses leadership and strategy — how to turn crisis management into effective management.

Speaker: **Peter Pastreich**, executive director,
San Francisco Symphony

CONCURRENT SESSIONS

Bradbury/Rose

■ Power Tools for Powerful Fund Raising

Attend this information-packed round table session and learn from the experts. You will change tables to hear two topics.

Coordinator: **Ted Roberts**, development director, Mama's Kitchen; former executive director, San Francisco Chamber Orchestra

Table 1

Finding New Donors

Sue Swan, associate director of development,
Los Angeles Philharmonic

Table 2

Prepare Your Case Statement

Susan Swinburne, development director,
Los Angeles Chamber Orchestra

Table 3

Creatively Package Your Proposals for Winning Results

Jamie Whittington, organizational consultant,
San Francisco

Table 4

Run a One-person Fund Raising Department

Karine Beesley, director,
The John Anton Ford Theatre Foundation

Table 5

Create Partnership Sponsors

Shirley Lewis, president/ceo, San Jose Symphony

Museum A

■ Special Event Construction

When the guests arrive, the house looks perfect. But how many endless hours went into the plans, the landscape, the building itself? Special event architects share their successful fund raising ideas with you.

- Moderator:** *Shirley Davis*, coordinator volunteer services, Los Angeles Philharmonic
Panelists: *Fran Biles*, Pasadena Junior Philharmonic Committee
Linda Hedgepeth, president, Santa Barbara Symphony League
Judee Kendall, vice president of public relations & marketing, Glendale Symphony
Richard Siefert, president, Philharmonic Business and Professional Committee

1215 PM - 1:45 PM

Bunker Hill Luncheon

Keynote Speaker: *John Manceri*, music director, Hollywood Bowl Orchestra

Host: *James Ruggirello*, executive director, Japan America Symphony education consultant, Los Angeles Philharmonic

Sponsored by ICM Artists, Ltd.



CONCURRENT SESSIONS

2:00 PM - 3:30 PM

Museum A

■ A Foundation for the Future

Planned giving and endowment programs don't need to be a burden to you or too complicated for your constituents. Invest a little now and you'll reap big dividends later.

- Moderator:** *Christopher Minnes*, development director, Long Beach Symphony
Panelists: *David Ferner*, managing partner, Currie, Ferner, Scarpetta & DeVries
Cary K. Tamura, gift planning consultant Los Angeles

This session is sponsored by First Interstate Bank.

Museum B

■ At Least Ask, and Do Tell

How can you use your musicians off-stage? Some practical ideas for involving your orchestra members in fund raising, public relations and outreach programs.

- Moderator:** *Mark A. Jordan*, concertmaster, Modesto Symphony
Panelists: *David Young*, principal bass, Long Beach Symphony
David W. Grainger, principal bassoon, Sacramento Symphony

Bradbury

■ Proper Care of Your Precision Tools

A successful employee/employer relationship consists of more than the cursory annual evaluation and a periodic review of job descriptions. The expectations of both staff and board members must be clearly identified to ensure smooth running of the organizational machine. Presidents and board members who are on the personnel committee and responsible for hiring staff must attend this session.

- Speakers:** *Nancy Mims*, director of human resources, San Francisco Symphony
Joe A. Mattox, Ph.D., Intercultural Management Consultants

3:45 PM - 5:00 PM

Bunker Hill

CLOSING GENERAL SESSION

■ Wiring for the Future: Technology of the 21st Century and Our Orchestras

Several California artists and administrators who are leaders in the field of technology and how it can be applied to the performing arts will discuss the latest advances. You'll learn how technology can revolutionize everything from concert performances to how we market and provide access to new audiences. A not-to-miss Conference event!

- Moderator:** *Louis G. Spisto*, executive director, Pacific Symphony Orchestra
Panelists: *Bran Ferren*, senior vice president, creative technology, Walt Disney Imagineering
Kit Galloway, Electric Cafe International
Jay Heifetz, CEO, Calliope Media

6:30 PM Dinner

Angel's Flight Restaurant, Hotel Inter-Continental

Guest Speaker: *Omus Hirshbein*, director music programs, National Endowment for the Arts

Dinner sponsored by Columbia Artists Management, Inc.

Concert

The California Plaza Watercourt

with members of the Los Angeles Chamber Orchestra,
Ransom Wilson, guest conductor

Concert partially underwritten by California Plaza, the AFM Music Performance Trust Fund and the Los Angeles County Music and Performing Arts Commission.



Conductors

DAVID ANDRÉ, *Music Director & Conductor*
Tulay County Symphony Orchestra

BOGIDAR AVRAMOV, *Music Director & Conductor*
Beverly Hills Symphony Festival at Mammoth Lakes

DAVID LEWIS CROSBY, *Conductor & Music Director*
Wisconsin Chamber Orchestra
American Master Chorus and Orchestras

MICHAEL HOFFMAN, *Principal Guest Conductor*
Maverick Radio and Television Orchestra

WES KENNEY, *Conductor & Music Director*
Oakland Youth Orchestra

STEFAN KOZINSKI, *Conductor*
Opera Delaware

NAVROJ MEHTA, *Conductor & Music Director*
Alaska Park Symphony

THOMAS OSBORN, *Conductor & Music Director*
Downey Symphony

MIGUEL PATRÓN-MARCHAND
Resident Conductor
National Opera and Ballet, Santiago, Chile

ALBERT ROSEN, *Conductor Laureate*
Radio Eterna Teleña Symphony Orchestra
Conductor National Opera, Prague;
Music Director, Irish National Opera

MATS GUSTAF RYDEN
Conductor & Music Director
Swedish Chamber Orchestra, Malmö Sweden

GERHARD SAMUEL, *Conductor*
Cincinnati Philharmonic Orchestra

Singers

KATHARINE LAWTON BROWN
Mezzo Soprano

JANET CAMPBELL,
Lyrical Mezzo Soprano

PAMELA HICKS
Soprano

Soloists

LEVON AMBARTSUMIAN, *Vocalist*
ANGELO PIANO DUO

ANTON BARAKHOVSKY, *Vocalist*
JEREMY COHEN, *Jazz Vocalist*
VLADIMIR MISCHUK, *Piano*
JOSHUA PIERCE, *Piano*
ORI STEINBERG, *Piano*

Ensembles

ARCO CHAMBER ORCHESTRA, *Minneapolis*
SHAROMOV VOCAL ENSEMBLE
First United States Tour 1990-91 Season

Special Attractions

GEORGE ENESCU PHILHARMONIC
ORCHESTRA BUCHAREST,
First United States Tour 1997-98 Season
LEGE ARTIS CHAMBER CHOIR

World Music

HAMZA EL DIN

Composers and Arrangers

STEFAN KOZINSKI

JAMES LAMB

RON MCFARLAND

GERHARD SAMUEL

JORDAN WARING

Joanne Corbett-Barnes, President
Michael Kaulkin, Associate
Laura Carmichael, Associate

2101 California Street, Suite 2
San Francisco, CA 94115-2870
Telephone: (415) 503-2505
Telefax: (415) 340-5205

CORBETT
ARTS MANAGEMENT, LTD.

Rile Management 1996-1997

PIANISTS

Dag Achatz
Sergei Babayan
Leon Bates
Nohema Fernández
Nina Leitchuk
Shirley Ling
Yin Cheng Zong

FORTEPIANIST

Malcolm Bilson

HARPSICHORDIST

Spencer Carroll

VIOLINISTS

Dylana Jensen
Sergiu Schwartz

VIOLIST

Marcus Thompson

CELLISTS

Anner Bylsmat
Claudio Jaffé
Csaba Orczay†
Torleif Thedéen†

GUITARISTS

Peter Segal
Emanuele Segret*

FLUTISTS

Harold Jones
Chris Norman, wooden
flutes*

CLARINETIST

Michel Lethiaet

OBOIST

Pamela Pecha, premiering
a concerto by Peter
Schickel

BASSOONIST

Milan Turkovitch

TRUMPETER

David Hickman

SOPRANOS

Julianne Baird*
Mattiwilda Dobbs
Alpha Floyd
Daisy Newman
Donna Roll
Eddie Pierce Young

TENOR

William Brown

BASS BARITONE

Benjamin Matthews

CONDUCTORS

Dalia Atlas
Leo Driehuyts
Paul Freeman
Stephen Gunzenhauser
Hugh Keelan*
Michael Krajewski
Nicholas Palmer
Henry Charles Smith
Taavo Virkhaus
Robert Vodnoy*

ENSEMBLES

Amsterdam Guitar Trio*
Audubon Quartet
Baltimore Consort
Chestnut Brass Company,
brass quintet
Guild Trio, piano trio
Haydn Trio Vienna,
piano trios†
Portland String Quartet
Stockholm Arts Trio,
piano trio

SYMPHONY POPS

ATTRactions

Gene Bertoni, jazz guitar
Best of Gilbert and Sullivan,
featuring stars of the
D'Oyly Carte
Brubeck Brothers, the second
generation of great jazz
(first time ever!)*
Crofut and Brubeck, featuring
Bill Crofut, Chris
Brubeck and Joel Brown—
jazz, pops, blues and folk;
Holiday program
Gerstwin by Request
featuring Leon Bates,
Eddie Pierce Young and
Benjamin Matthews
Symphonic Klezmer, a
swingin' klezmer band for
pops programs*
Symphonasaurus and Oh,
Daddy! featuring John
(Slim Goodbody) Bernstein

This is a partial list; write or
call for the complete roster.
* First season with Rile Mgmt.
† North America only.
‡ Not available for 1996-97.

Joanne Rile Management

BENSON EAST, SUITE 1206, JENKINTOWN, PA. 19046-3613
Tel: 215-885-6400 Fax: 215-885-9929
EMAIL: rilearts@aol.com

1994-95 ACSO BOARD OF DIRECTORS

EXECUTIVE COMMITTEE

Acting President/Board Development

Louis G. Spisto, executive director, Pacific Symphony Orchestra
Secretary

Phyllis Apfel, president, Santa Rosa Symphony

Treasurer

Bruce D. Thibodeau, executive director, Los Angeles Chamber Orchestra

Vice President/Communications

Patricia Gessner, director of marketing, San Francisco Symphony

Vice President/Membership

Joseph Truskot, executive director, Monterey County Symphony

Vice President/Development

Ted Roberts, development director, Mama's Kitchen, San Diego

Vice President/Education

James Ruggirello, executive director, Japan America Symphony

BOARD OF DIRECTORS

Karine Beesley, director, The John Anson Ford Theatre Foundation

Tim Beswick, director of operations, San Jose Symphony

Barbara Burger, marketing director, Santa Barbara Symphony

Amy Carson-Dwyer, artists representative, Colbert Artists Management

Denis de Coteau, music director, San Francisco Ballet

Christina Diver, board member, Interlochen Center for the Arts,
San Francisco Conservatory of Music

Mark Jordan, concertmaster, Modesto Symphony; director,
Alumni Relations, UCSF

Mitchell Sardou Klein, music director, Peninsula Symphony North

Diane Lent, president, Modesto Symphony

Sharon C. McNalley, board member, Orange County Philharmonic Society

Mike Morris, past president, Pasadena Symphony; attorney,
Morgan, Lewis & Bockius

Irene Klug Nielsen, executive director, Fresno Philharmonic

Helen C. Norton, executive director, Alzheimer's Society

Lynn Osmond, executive director, Sacramento Symphony

Asher Raboy, music director, Napa Valley Symphony

Dr. Sylvia Shepherd, board member, San Diego Chamber Orchestra

DIRECTORS EMERITI

Stewart Comer, Savannah, Georgia

Suzanne Dewar, Pebble Beach

Pauline Fisher, executive director, Santa Rosa Symphony

G. Michael Gehret, vice president, development and marketing,
Chicago Symphony

Don Jones, Napa Valley

Jean Squair, Santa Rosa

STAFF

Kris W. Saslow, executive director

Jennifer Pimbley, administrative assistant

Association of California Symphony Orchestras

P.O. Box 255445, Sacramento, CA 95865

(916) 484-6744 FAX (916) 484-0505

VINTAGE JAZZ
Bone Gibson & The New Orleans Hot Jazz
Dazzling Vocalist, Stellar Band

The Live Colburn Jazz Band
Stars of Public Radio's
"Riverwalk, Live from The Landing"

James Dapogny's Chicago Jazz Band
Small Band Swing, Got-Down Piano

Butch Thompson/Butch Thompson Trio
Sparkling, Early Jazz Piano

SINGER - SONGWRITERS
The Chenille Sisters
Close Harmonies & Fun

David Holt
Minstrel/Storyteller

WORLD/ETHNIC
Finian
A Klezmer Band

VOCALIST
Carla Connors
Soprano

SPECIAL ATTRACTIONS
Dick Hyman
William Warfield



Donna Zajonc Management
(800) 650-5742

SEIGEL ARTIST MANAGEMENT

INTRODUCING STEFAN SCAGGIARI

Pianist/Composer and Concord Recording Artist performs in both classical and jazz settings, either as symphony soloist and/or swinging with his jazz trio. NPR's **Weekend Edition** broadcasts Stef's music to millions of listeners each Sunday, while critics acclaim his performances at the Kennedy Center with Dizzy Gillespie and at Carnegie Hall with Eugene List. **From Mozart to Monk, Stefan Scaggiari has it all! Grappelli does it on fiddle, Scaggiari does it on piano.**

POPS*

Amherst Saxophone Quartet

Dukes of Dixieland

New Arts Six (Holiday Show)

Olivera & Del Moral

"Celebration of Spanish
Dance"

Three on a String

Country, Bluegrass & Folk

SOLOISTS

Deborah Hoffman, Harp

Sarah Johnson, Violin

David Kim, Violin

Kevin Sharpe, Piano

Ana-Maria Vera, Piano

Robert Zimansky, Violin

* Symphony Charts

Ethel Siegel, Dir. Special Projects
3003 Van Ness Street, NW, Suite W205
Washington, DC 20008
Ph: 202-966-0003 Fax: 202-363-3811



SCHWEICKERT & COMPANY

INSURANCE AGENTS, BROKERS & MANAGERS

Managers of the

AQSO

Workers' Compensation
Insurance Program

714-436-6400
1-800-748-6293

Serving all of the
insurance needs of the
performing arts community
in California for over 20 years.

One Master and Two Rising Stars from Jonathan Wentworth Associates Ltd.

Anton Kuerti, piano

Like the bouquet of fine wine, the artistry of Anton Kuerti gains ever more distinction over time. His Beethoven has been called "imperial"; his Schumann "vital and exquisitely defined". Anton Kuerti will give recitals, chamber music and concerto performances in California this season.

"He is an artists of serious purpose and courage"
New York Times

Christopher Taylor, piano 1993 Van Cliburn Bronze Medalist

A young pianist whose artistry has been recognized by two California orchestras and at the most recent Van Cliburn competition, Christopher Taylor will play this season in New York, Chicago, Seoul and at the Kennedy Center, among his many engagements, that include two California appearances.

"...one of the prize performances of this or any other season... the greatest performance of the concerto you ever heard."
Sacramento Bee

Lee-Chin Siow, violin Winner in three major recent competitions

Over a period of less than two years, Lee-Chin Siow has won the Henryk Szeryng Competition, the McMahon Competition and most recently was a winner at the Houston Symphony's Young Artists Competition. Whether in recital or playing a concerto, her music making is something special.

"Siow threw off the Zimbalist arrangement of Sarasate's 'Carmen Fantasy' with enormous style."

The Province (Vancouver)

 **JONATHAN
WENTWORTH
ASSOCIATES LTD.**

100 Stevens Ave., Suite 503
Mt. Vernon, NY 10550
914.667.0707
JWentAssoc@aol.com



AN
EVENING
WITH

John Bayless
piano

"A modern-day Franz
Liszt."

— Classical CD

"Bayless made my chin
drop, both artistically
and technically...awe-
inspiring."

— CD Review

*West Side Story Variations**

Angelo Records release

*Bach Meets the Beatles**

Angelo Records release

Rhapsody in Blue

* sample provided for comparison



international artists group
212.987.3038 • 212.369.3103 fax 102053.1051@compuserve.com