

# 2023 COTY SUBMISSION

**NARI MINNESOTA**

**FRENCH COUNTRY PRIMARY ENSUITE**

**RESIDENTIAL BATH \$40,000 TO \$70,000**





# ABOUT THE PROJECT

This primary bathroom lacked style and updating found throughout the home. Although this bathroom had the space for a double sink vanity, jetted tub and stand alone shower, the bathroom did not function well for our clients. They expressed the need for a bigger shower, more storage and a more luxurious feel that matched the aesthetic of their home.

## CLIENT DESIRES:

**LARGER SHOWER**  
**FREE STANDING SOAKING TUB**  
**ADDED STORAGE**  
**NEW WINDOW**  
**LUXURIOUS FEEL**  
**TIE INTO REST OF THE HOME**





# BEFORE FLOOR PLAN

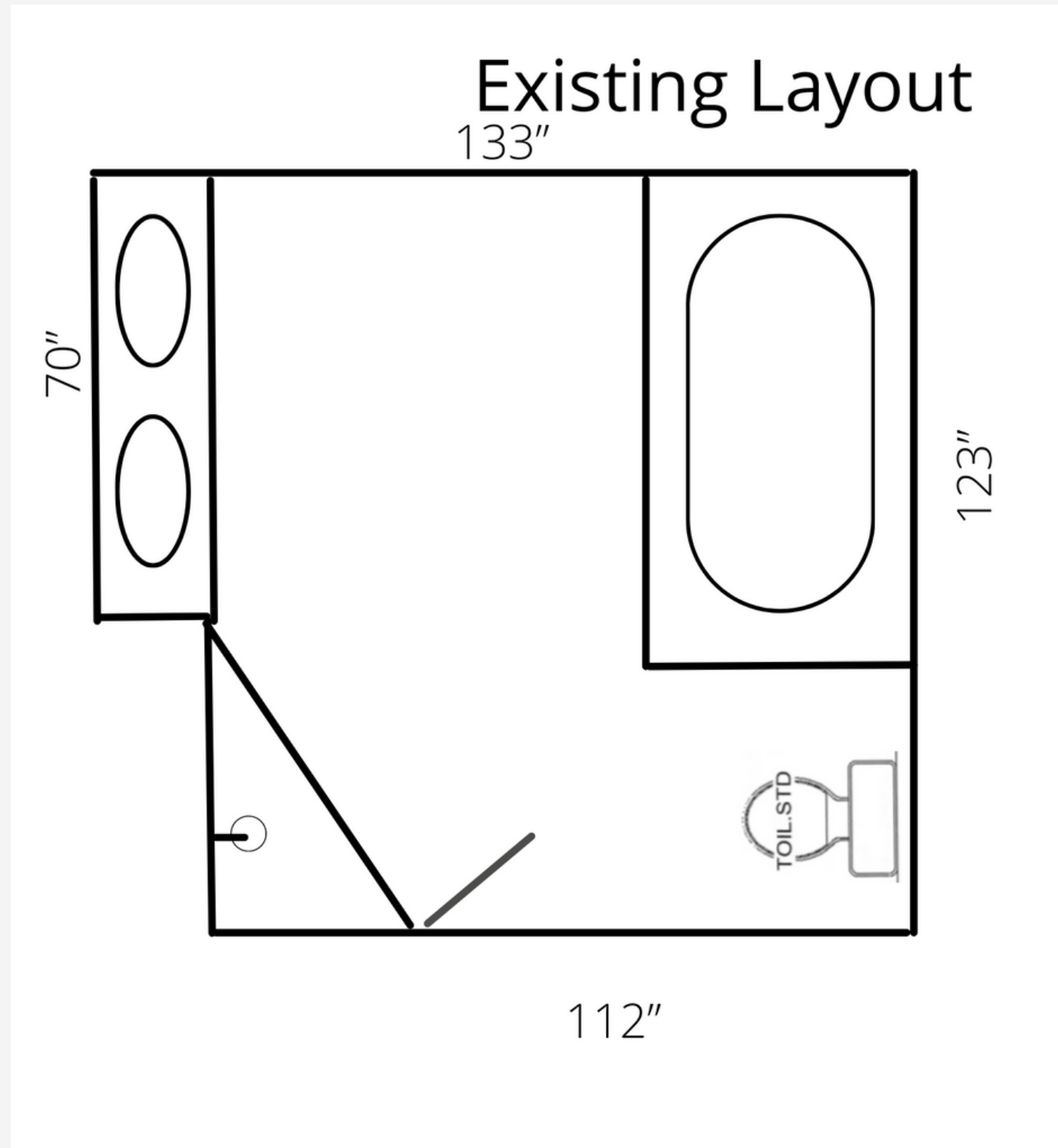

## SCOPE OF WORK

- Enlarge shower footprint
- Replace window
- Remove jetted tub
- Remove old vanity
- Remove dated tile
- Remove soffiting
- Remove old millwork





**BEFORE  
PICTURES**





# AFTER FLOOR PLAN + RENDERING

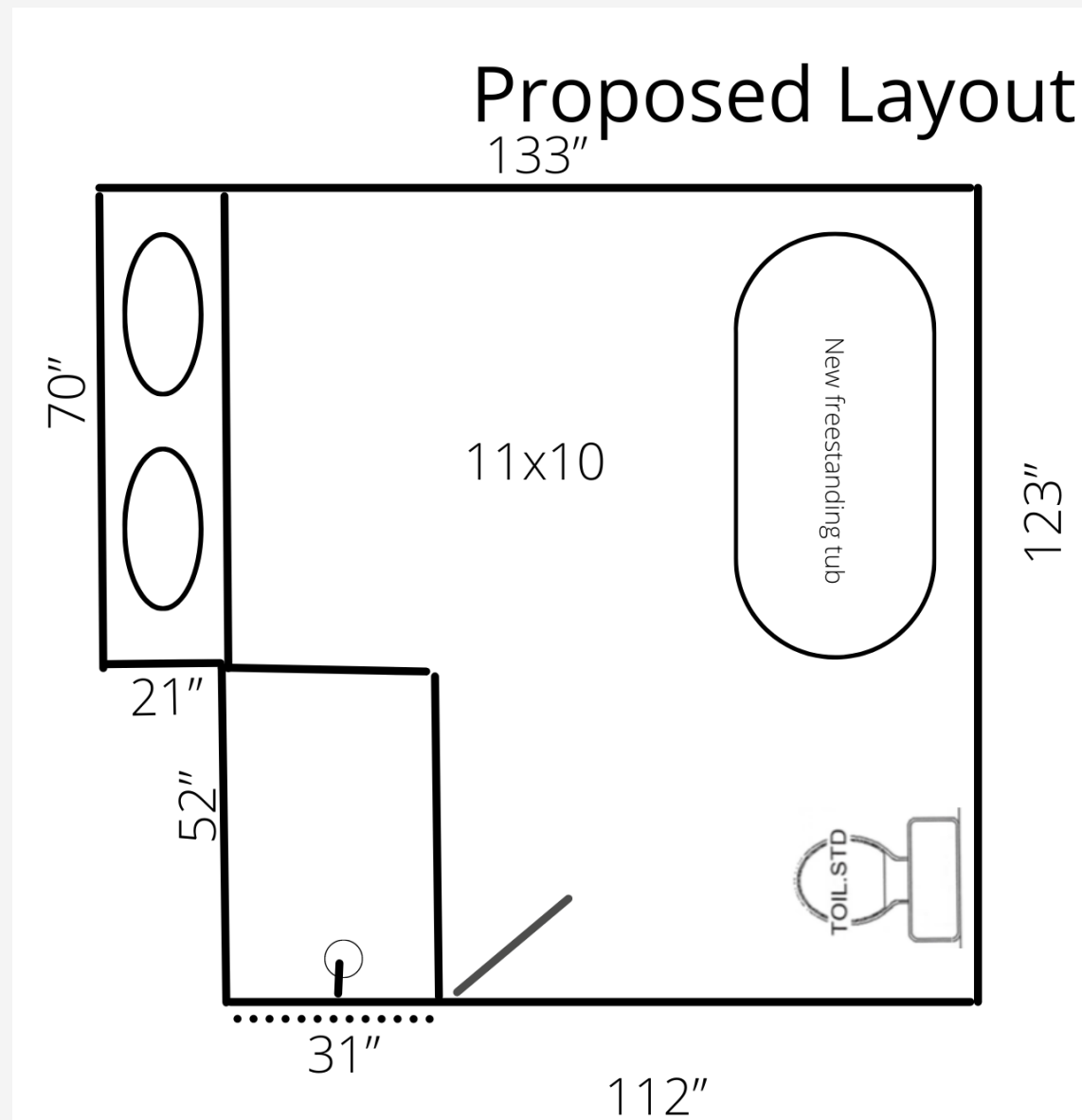

## MEETING CLIENT NEEDS

- Custom matching vanity and linen cabinet
- New free-standing tub
- Larger shower footprint with custom glass
- New bidet toilet
- New floor and shower tile





VISION BROUGHT TO LIFE





# BEFORE



# AFTER





## FUNCTIONALITY

- Closed storage for towels and soaps
- Free standing soaking tub for more spacious layout
- Larger shower with custom glass
- Lighter colors that brighten up the room
- Bidet toilet
- Handheld shower slide bar
- Panasonic bath fan with timer
- Outlets inside of cabinetry for concealed charging/plugins





# BEFORE



# AFTER







## CRAFTSMANSHIP DETAILS

- Matching Cambria quartz shower curb
- Custom niche with arabesque tile + glass shelving
- Frameless shower door with matching hardware
- Herringbone tile pattern flooring
- Custom vanity and linen cabinet with tulip bun feet
- Millwork matched to existing home casing





# BEFORE



# AFTER







## **AESTHETICS**

The design for this primary suite was centered around the client's classic french farmhouse style with an elegant touch that is found throughout the home. Light and airy colors give the space a tranquil luxurious feel. The mix of polished and brushed nickel metals add a little glitz and glam. From the soft milk glass vanity fixtures to the dainty crystal knobs, every detail was expertly curated.





## OBSTACLES

The bathroom is located on the side of the home on the second story; making it hard to access since the ground below slopes down into a pond towards the back of the home. We knew we would need to get creative when replacing this window. We rented a telescoping boom lift which helped lift the window into place as well as provided safety on ice during a winter install. Fun Fact: The boom lift rental cost matched the cost of the window itself.



# NARI MINNESOTA

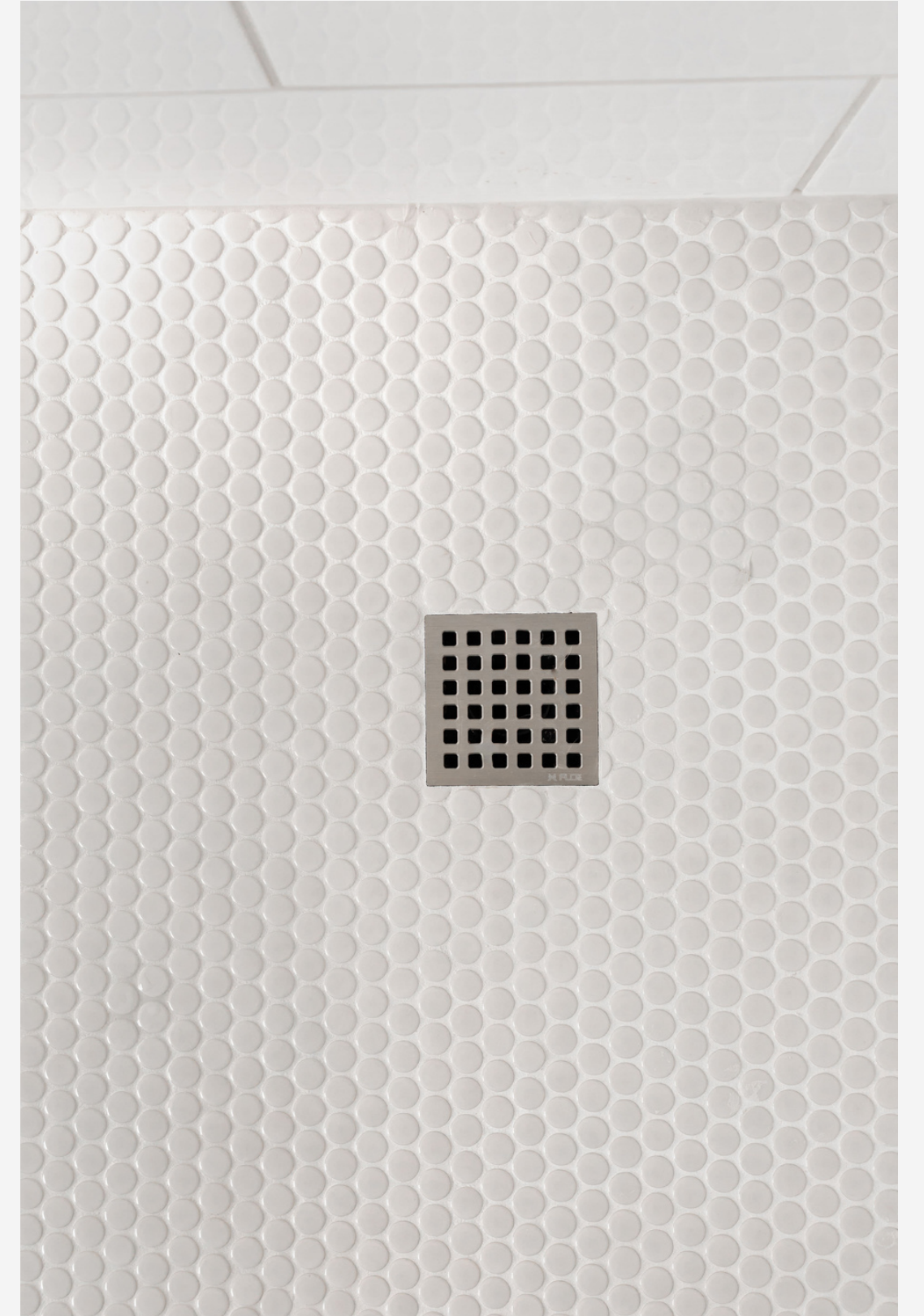

**RESIDENTIAL BATH \$40,000 TO \$70,000**