



LAMAR COUNTY CHAMBER OF COMMERCE PRESENTS

ALL BREED BULL SALE

INCLUDING HAND SELECTED OPEN
& BRED HEIFERS AND COWS

details

BULL SESSION & CHILI SUPPER
NOV 27TH, 2023
5:00 PM

BULL SALE
NOV 28, 2023
1:00 PM



CATTLEMAN'S LIVESTOCK COMMISSION CO
1354 CLEMENT RD, PARIS TX 75460
(903) 784-2238

2550 Lamar Avenue
Paris, Texas 75460

903-785-8484

CENTURY 21 FARM & RANCH®

c21farm-ranch.com

c21php.com

A M E R I C A N
F A R M + R A N C H

LANDBROKERcoop

Harvey Properties



316 ACRE CATTLE RANCH

316± Acres | Listed at \$1,884,000



APPLEGATE RANCH

130± Acres | Listed at \$1,350,000

\$523MM in American Farm + Ranch Member SALES in 2022

ACCREDITED LAND CONSULTANTS - LAND SPECIALISTS - LAND EXPERTS

Century 21 Harvey Properties has been serving Texas, Colorado and Oklahoma for over three decades.

We hold customer service in the highest regard. Our agriculture backgrounds and formal education allow us to provide comprehensive consultation as it relates to farming, ranching, timberland, and recreational properties and land values.

**AT CENTURY 21 HARVEY PROPERTIES,
WE ARE STEWARDS OF THE LAND AND WE LIVE WHAT WE SELL.**

OUR SERVICES:

- Full Service Commercial, Farm and Ranch, Recreational and Agribusiness Brokerage
- Section 1031/33 Exchanges • Appraisals • Crop, Livestock, Wildlife and Timber Consulting
- Farm and Ranch Management & Consultation, from Day-to-Day Operations to Finding Tenancy



NORTH EAST TEXAS EQUESTRIAN ESTATE

9.7± Acres | Listed at \$995,000



SETTOON ESTATE RANCH

148± Acres | Listed at \$900,000

RUSTY LOWE, ALC
Broker, Land Specialist

903-782-4010 | rustylowe@c21php.com



CLAYTON PILGRIM, ALC
Realtor, Land Specialist

903-767-1628 | clayton@c21php.com

Welcome

TO THE

58th ANNUAL Red River Valley ALL BREED BULL SALE

TUESDAY
November 28, 2023
1:00 PM

CATTLEMEN'S LIVESTOCK COMMISSION
Charles Mallicote

Paris, Texas

LUNCH AVAILABLE

Lamar Co. Chamber of Commerce
Bull Sale Committee
2023-2024

Agriculture Committee

Bryan Glass Chairman
Mark Buster
Charles Mallicote
Marc White, D.V.M.
Renee Harvey
Brad Nutt
Cary Van Duke
Shane Phifer
Wally Kraft, D.V.M.
Rusty Lowe
Lynn Patterson
Mike Morrow

Chamber Staff

Russell Jackson - Chamber Board Chairman
Paul Allen, Chamber President/CEO
Gina Crawford, Director of Operations
Becky Semple, Director of Tourism
Karen Dougherty, Admin. Assistant
Judy Daniel, ABBS Coordinator, Sec.
Raegan Buster, Event Coordinator

BULL SESSION

- 5:00 Consignors draw for Sale Order. “Let’s Eat Chili!!
- 6:00 “Welcome” by Bull Sale Agriculture Committee Chairman, Bryan Glass for 2023-2024.
Chairman of Lamar County Chamber of Commerce, Russell Jackson.
Scholarship Award Recognition!
Baked Goods Auction to benefit 4-H and FFA Students in Lamar County Schools.
- 6:30 Guest Speaker, Colton Spencer, Corteva Agriscience.
- 7:30 Open viewing and meet the consignors.



Colton Spencer

Topic:

Managing Pastures and Hay Meadows Using
Herbicides.

I grew up on a registered Gelbvieh and Balancer cow/calf operation in Aurora, Missouri. After graduating from the University of Missouri, I moved to Texas and have worked for Corteva Agriscience as a Range and Pasture Specialist for 3.5 years in northeast and north central Texas. I am passionate about the agriculture industry and the beef industry specifically. I believe the cornerstone of a good operation is pasture management and enjoy assisting ranchers in accomplishing this goal!

TERMS & CONDTIONS

TIME: Sale will begin at 1:00 PM.

BIDDING: Each animal will be sold to the highest bidder.

TERMS: The terms of the sale are cash.

DISPUTES: The owner of Cattlemen's Livestock Commission will settle any disputes as to bids.

HANDLING: Each animal will be at the purchaser's risk as soon as sold. Cattlemen's Livestock Commission Co., and the Lamar County Chamber of Commerce assume no risk or liability for any bull consigned to the sale. Cattlemen's Livestock Commission Co. livestock insurance is not in effect for this special auction.

BREEDING GUARANTEE: All animals are guaranteed breeders. Any animal that has not proven itself a breeder within six months after the sale, if in healthy condition, may be returned to the ranch of the seller, at the buyer's expense. The seller reserves the privilege of trying, for a period of six months, to prove the animal a breeder. If proven a breeder, the animal will be returned at the buyer's expense. Should the animal fail to prove a breeder in the specified period, an adjustment will be made by the seller either by substituting an animal mutually agreed upon as being of equal value or the refund of the full purchase which shall be considered as full settlement and satisfaction of all claims. All complaints regarding breeding difficulties must be reported in writing by the buyer and seller. Sale management or sponsorship is not involved.

ANNOUNCEMENTS: All announcements from the auction box will take precedence over the printed matter in this catalog.

LIABILITY: All persons who attend the sale do so at their own risk. The owners and the Sale Manager, Lamar County Chamber of Commerce, Cattlemen's Livestock Commission Co. assume no liability, legal or otherwise, for any accidents which may occur.

CONTRACT: The above terms and guarantee shall constitute a contract between the buyer and seller of each animal sold.

HEALTH: The cattle have all been tested for Brucellosis within 30 days of sale date or have a Brucellosis free herd.

Health certificates acceptable in any state or Canada will be furnished.

Always your
FIRST
choice!



Personal | Business | Home Loans



FIRST FEDERAL
COMMUNITY BANK, SSB

Paris Downtown | Paris Loop
903-784-0881 | www.FFCBank.com

ANGUS

W R Ranch, Greenville, Tx.	6
Gary DeGarso, Greenville, Tx.	2
GW Ranch, Omaha, Tx.	4
Outfit 8, Bay, Mo.	2
Express Ranch, Yukon, Ok	8
JirI Buck, Madill, Ok.	1
Shay Navia, Deport, Tx.	1

BRANGUS

Lynn Patterson, Brookston, Tx.	8
Phil Smith, Roxton, Tx.	4

BEEFMASTER

Diamond T Ranch	1
Curtis & Barbara Fendley, Paris, Tx.	4

CHAROLAIS

Cook Cattle, LLC, Shreveport, La.	4
Stretcher Charolais, Mt. Vernon, Tx.	2
Bar A Charolais, Howe, Tx.	2
Bayvue Farms, Bay, Mo.	3
Baily O Braun, Jefferson, MO.	3
Robert Gaston, Canton, Tx.	3
Wheatcraft Farms, Brookfield, Mo.	10
Kason Foster, Brookfield, Mo.	6

HEREFORD

Stewart Polled Herefords, Campbell, Tx.	2
R. Schlegel & Sons, Olney, Tx.	3
Buck Cattle Co., Madill, Ok.	10
4F Cattle Co., Whitesboro, Tx.	1
4S Farms, LLC, Denison, Tx.	4
RK Cattle Co., Dodd City, Tx.	4
Jamison Ranch, Madill, Ok.	3

MAINE ANJOU

Jeril Buck, Madill, Ok.	4
-------------------------	---

SANTA GERTRUDIS

Nicholas O'Neal, Como, Tx.	1
----------------------------	---

ANGUS

Angus Breed EPD Averages-Fall 2023

	CEB	BW	WW	YW	RADG	DMI	YH	HS
Current Sires	+6	+1.2	+61	+108	+25	+98	+5	+54

HP	CEM	Milk	MW	MH	\$EN	CW	Marb	RE	Fat
+11.6	+8	+26	+59	+3	-14	+44	+56	+58	+0.12

Lot 4 **WR 901-173** **AAA 20357448**
 [MIP]
 Calved 08/12/2021 Consigned by: W R Ranch
 Tattoo 101 Greenville, Tx.

G A R SURE FIRE AAA#+*17328461 [RDF]
WR SURE FIRE- 901 AAA+*19724034
 R B BLACKCAP 234 AAA *17466772

WR TEN X OF 302 155 AAA+*18100351
WR 10X 155 OF 805 AAA18783705
 WR 1114G OF 7884 AAA 18137975

EPDS: NONE.

Lot 1 **WR 9Q56** **AAA 20335314**

Calved 03/02/2021 Consigned by: W R Ranch
 Tattoo 56 Greenville, Tx.

RITO 9Q13 OF RITA 5F56 GHM AAA#+*16408438
WR 9Q13 OF 1X78 055 AAA+*18099629
 CAF/TMR LADY RITA 1X78 AAA+16942195

WR TEN X OF 302 155 AAA+*18100351
WR10X 155 OF 7 AAA 18783711
 WR FUSION OF 9155C AAA 18142749

EPDS: CED +4, BW +3.6, WW +57, YW +109,CEM +11, Milk +25..

Lot 5 **WR 901-179** **AAA 20357447**

Calved 09/01/2021 Consigned by: W R Ranch
 Tattoo 102 Greenville, Tx.

G A R SURE FIRE AAA#+*17328461 [RDF]
WR SURE FIRE- 901 AAA+*19724034
 R B BLACKCAP 234 AAA *17466772

WR TEN X OF 302 155 AAA+*18100351
WR 10X 155 OF 1613 AAA 18783709
 WR 1114G OF 813 AAA 18137977

EPDS: NONE.

~~**Lot 2** **WR 9Q 54** **AAA 20335315**
 [DDP]
 Calved 03/04/2021 Consigned by: W R Ranch
 Tattoo 54 Greenville, Tx.~~

~~RITO 9Q13 OF RITA 5F56 GHM AAA#+*16408438 [DDF]
WR 9Q13 OF 1X78 055 AAA+*18099629
 CAF/TMR LADY RITA 1X78 AAA+16942195~~

~~WR 9Q13 OF 1X78 045 AAA+*18099628
WR 9Q13 OF 07 AAA 18783716
 WR 813 AAA16314111~~

EPDS: NONE.

Lot 6 **WR 104** **AAA 20361439**

Calved 01/20/2022 Consigned by: W R Ranch
 Tattoo 104 Greenville, Tx.

E W A PEYTON 642 AAA *18675107 [RDF]
WR PEYTON 904 AAA +*19734884
 MONTANNA RITA B074 AAA +*17943260

WR TEN X OF 302 155 AAA+*18100351
WR10X 155 OF 7 AAA 18783711
 WR FUSION OF 9155C AAA 18142749

EPDS: NONE.

Lot 3 **WR 9Q 55** **AAA 20335313**

Calved 03/01/2021 Consigned by: W R Ranch
 Tattoo 55 Greenville, Tx.

RITO 9Q13 OF RITA 5F56 GHM AAA#+*16408438
WR 9Q13 OF 1X78 055 AAA+*18099629
 CAF/TMR LADY RITA 1X78 AAA+16942195

WR TEN X OF 302 155 AAA+*18100351
WR10X 155 OF 801 AAA18783710
 WR114G OF 7153 AAA 18137979

EPDS: CED +5, BW +3.0,WW +55,WYW +103, CEM +10, Milk +27.

Lot 7 **WR 105** **AAA 20361438**
 [DDP]

Calved 01/20/2022 Consigned by: W R Ranch
 Tattoo 105 Greenville, Tx.

E W A PEYTON 642 AAA *18675107 [RDF-DDF]
WR PEYTON 904 AAA +*19734884
 MONTANNA RITA B074 AAA +*17943260

WR 9Q13 OF 1X78 045 AAA+*18099628
WR 9Q13 OF 07 AAA 18783716
 WR813

EPDS: NONE.

Lot 8 Calved 04/29/2022 Tattoo 042 G A R SURE FIRE WR SURE FIRE- 901 R B BLACKCAP 234 WR 9Q13 of 1X78 055 WR JOURNEY 922 WR JOURNEY of G913 EPDS: CED +6, BW +1.5, WW +53, YW +95, CEM +9, Milk +25.	042 Consigned by: Gary DeGarso Greenville, Tx. AAA #+*17328461 [RDF] AAA+*19724034 AAA *17466772 AAA +*18099629 AAA *19877648 AAA 17899086	Lot 12 GW ROCK AAA +20760323 Calved 02/26/2022 Tattoo 8481 A A R TEN X 7008 S A V A R DISCOVERY 2240 DEER VALLEY RITA 0308 BR MIDLAND EXAR RITA 5317 G A R EXT 1204 EPDS: CED +4, BW +1.9, WW +52, YW +99, CEM +11, Milk +23..	Consigned by: GW Ranch Omaha, Tx. AAA #*15719841 AAA #*17262835 [RDF] AAA +*16659293 AAA #13898124 AAA +14930626 AAA +12304064
Lot 9 Calved 05/26/2022 Tattoo 052 G A R SURE FIRE WR SURE FIRE- 901 R B BLACKCAP 234 WR JOURNEY-1X74 WR RITA 8017 MONTANA RITA B074 EPDS: CED +5, BW +1.3, WW +73, YW +128, CEM +9, Milk +32..	052 Consigned by: Gary DeGarso Greenville, Tx. AAA #+*17328461 [RDF] AAA+*19724034 AAA *17466772 AAA #+*16924332 AAA +*19208296 AAA +*17943260	Lot 13 GW WEATHERBY AAA +20760325 Calved 02/22/2022 Tattoo 8483 B/R FUTURE DIRECTION 426€ V A R DISCOVERY 2240 2 BAR 5050 NEW DESIGN 7831 E&B 1680 PRECISION 1023 COX VIXON 9069 BRICTON VIXON 4276 EPDS: CED +9, BW .1, WW +40, YW +63, CEM +11, Milk +28..	Consigned by: GW Ranch Omaha, Tx. AAA *14675477 AAA #*17262835 [RDF] AAA 15724629 AAA #+13913492 AAA 16258416 AAA 15052687
Lot 10 GW SPARTACUS AAA +20761622 Calved 01/28/2022 Tattoo 8492 MCC DAYBREAK QUAKER HILL RAMPAGE 0A36 QHF BLACKCAP 6E2 of4V16 4355 SS OBJECTIVE T510 0T26 COX MS FOCUS 9059 G A R FOCUS 501 EPDS: CED +7, BW +1.8, WW +68, YW +114, CEM +10, Milk +18..	AAA +20761622 Consigned by: GW Ranch Omaha, Tx. AAA #14777016 AAA #+*16925771 [RDF] AAA +*15601886 AAA #*13776378 AAA +16236323 AAA +14116251	Lot 14 08 RAMPAGE 2120 Pending Calved 08/12/2021 Tattoo 2120 QUAKER HILL RAMPAGE OA36 MILLS RAMPAGE 234 MILLS MILL 049 LASS 58 NICHOLS EXTRA K205 RITA 8K15 OF RITA 5819 K205 RITA 5819 OF RITA 1B2 878 Actual BW 68 lbs. WW 603 lbs EPDS:	Consigned by: Outfit 8 Bay, Mo. 16925771 18189252 13752642 15964644 14934669
 Lot 11 GW RAGNOR AAA +20760324 Calved 03/02/2022 Tattoo 8493 A A R TEN X 7008 S A V A R DISCOVERY 2240 DEER VALLEY RITA 0308 BR MIDLAND EXAR RITA 5317 G A R EXT 1204 EPDS: CED +4, BW +1.9, WW +52, YW +99, CEM +11, Milk +23.. 	 AAA +20760324 Consigned by: GW Ranch Omaha, Tx. AAA #*15719841 AAA #*17262835 [RDF] AAA +*16659293 AAA #13898124 AAA +14930626 AAA +12304064 	Lot 15 08 RESOURCE 2147 Pending Calved 11/30/2021 Tattoo 2147 SAV RESOURCE 1441 CAPITAL RESOURCES 3636 BRAZOS VALLEY UPWARD 9922 HYLINE RIGHT TIME 338 RITA 8D38 OF RITA 2V21 338 RITA 2V21 OF RITA 7W51407 Actual BW 65 lbs. WW 610 lbs EPDS:	Consigned by: Outfit 8 Bay, Mo. 18528537 17328604 13058662 15996155 14200796

Since 1980

"We Deed Happiness"



PARIS REAL ESTATE
3011 LAMAR AVE | (903)785-4563



Mary Lou Coe, GRI
903-785-4563



Shelley (Coe) Briggie
903-817-7918



Brad Coe
903-817-2701



Taunya Coe Smyers
903-669-9727



Jarrod Briggie
903-491-9501

When you see us, you're one step closer to home.



Meagen Smith
903-495-4645



Cortney Brown
903-495-8927



Christi Coe
903-817-4264



Chastiti Briggie
903-249-4663

We'll find you a home to love!

SELLING: FARMS, RANCHES, HOMES, COMMERCIAL

Email: parisrealestate@suddenlinkmail.com

PARISTXREALESTATE.COM

Paris Real Estate

Paris Real Estate Owner Mary Lou Coe has been in business at the same location at 3011 Lamar in Paris since 1980.

Her husband of 66 years, Bill Coe, passed away in 2018.

They have a 3-generation business, Shelley Briggie, their daughter, who has been with the company since 1991, their son and daughter-in-law, Brad Coe and wife, Christi Coe, their daughter, Taunya Coe Smyers, their grandson, Jarrod Briggie and granddaughter-in-law, Chastiti Nation Briggie. We are Blessed to have Meagen (Ford) Smith and Cortney Brown. Carolyn Wheelchel who has been with the company since 1982, retired this year.

Mary Lou has four children, Shelley Briggie and Jerrell, Taunya Smyers and Joe, Billy Coe Jr., Brad Coe and wife, Christi Coe. Brad retired from Kimberly Clark after 37 years, and came with us fulltime in 2021, and several grandchildren and great-grandchildren.

Mary Lou has her GRI designation (Graduate Real-estate Institute).

The Coe's invite you to stop by their office for information on buying or selling your property. We are proud to be a part of Paris. We offer

the best in sales and service in our business. We stand ready and are fully qualified to help you in any of your needs. We make home buying a pleasure and affordable. When you see us, you are one step closer to home.

Mary Lou was born in Lamar County, the fourth of nine children. She graduated from East Lamar in 1952. She and Bill were married in October of 1952. Bill retired from the military in 1985 after 38 years of service. Mary Lou has been very involved in the community. Some of her activities are: graduate of Realtors Institute of Texas in 1978, Texas Association of Realtors, National Association of Realtors, Paris Board of Realtors, Realtor of the Year, voted Paris' Best Realtor by Paris News readers in 2011, 2012, 2014, 2016, 2017, 2018, 2019, 2020, 2021 & 2022, Business & Professional Woman of the Year, Lamar County Leadership Class of 1987, Chamber of Commerce Director, Member of Lamar County Ambassadors, Visitors & Convention Council, Salvation Army Advisory Board, Paris Business Women's Club and a member of East Paris Baptist Church.

Our office specializes in residential, farms, ranches, commercial and investment property. Come by 3011 Lamar. Our office hours are 8:00 am to 5:00 pm Monday thru Friday and till noon on Saturday.

Lot 16 EXAR SUPERIOR 2055B 20280522
 100% AN POLLED
 Calved 1/20/2022 Consigned by: Express Ranch
 Tattoo 2055B Yukon, Ok.

A A R Ten X 7008 S A Act BW
 EXAR Stud 4658B 89
 BoBo Rita 1559 Adj WW
 EXAR Superior 752
 Connealy Consensus 7229 Adj YW
 44 Blackcap 1752 1442
 Sandpoint Blackcap 7977 Adj Yrlg SC
 Varilek Product 2010 04 38
 3F Epic 4631 Adj IMF
 Zebo Queen 1072 4.41
 EXAR Rita 9724 Adj REA
 Connealy Consensus 7229 15.00
 EXAR Rita 6131 Adj Fat
 EXAR Rita U049 0.36

CED	BW	WW	YW	RADG	DMI	SC	Doc	Claw	Angle	PAP	HS	HP	CEM	Milk
5.00	2.1	84	156	0.30	2.32	0.44	15	0.71	0.57	3.05	0.64	12.9	6.00	14
\$EN	CW	Marb	REA	Fat	\$M	\$W	\$F	\$G	\$B	\$C	\$AxH	\$AxJ		
-41	60.00	0.74	0.80	-0.026	31	58	94	63	157	235	90	59		

Great adj YW at 1442 along with a 15.0 inch ribeye.

Lot 19 EXAR RAWHIDE 1867B +20259436
 100% AN POLLED
 Calved 9/10/2021 Consigned by: Express Ranch
 Tattoo 1867B Yukon, Ok.

Basin Payweight 1682 Act BW
 Poss Maverick 77
 Poss Pride 5163 Adj WW
 Poss Rawhide 751
 Poss Easy Impact 0119 Adj YW
 Poss Blueblood 6502 1271
 Poss Blueblood 920 Adj Yrlg SC
 Connealy Consensus 33
 Connealy Consensus 7229 Adj IMF
 Blue Lilly of Conanga 16 3.50
 44 Blackcap 1752 Adj REA
 S S Objective T510 0T26 16.60
 Sandpoint Blackcap 7977 Adj Fat
 G A R Load Up 1682 0.49

CED	BW	WW	YW	RADG	DMI	SC	Doc	Claw	Angle	PAP	HS	HP	CEM	Milk
10.00	1.7	80	133	0.25	1.41	1.09	31	0.55	0.40	0.47	0.87	6.2	11.00	17
\$EN	CW	Marb	REA	Fat	\$M	\$W	\$F	\$G	\$B	\$C	\$AxH	\$AxJ		
-26	68.00	0.51	0.80	0.046	52	66	110	45	155	253	143	150		

Tremendous pedigree with this POSS Rawhide son who's low birth, high growth numbers are appealing.

Lot 17 EXAR JET FUEL 2377B 20276555
 100% AN POLLED
 Calved 2/01/2022 Consigned by: Express Ranch
 Tattoo 2377B Yukon, Ok.

Connealy Black Granite Act BW
 Bar R Jet Black 5063 78
 Bar R Iris Anita 0113 Adj WW
 EXAR Jet Fuel 9706B 731
 Sitz Top Game 561X Adj YW
 EXAR Lucy 5727 1349
 EXAR Lucy 0901 Adj Yrlg SC
 40
 EXAR Denver 2002B Adj IMF
 EXAR Avatar 5516B 6.61
 EXAR Lass 0129 6.61
 EXAR Erica Dianna 9383 Adj REA
 EXAR Credence 4590B 15.70
 EXAR Erica Dianna 4958 Adj Fat
 Monarch Erica Dianna Y100 0.41

CED	BW	WW	YW	RADG	DMI	SC	Doc	Claw	Angle	PAP	HS	HP	CEM	Milk
7.00	2.5	83	148	0.30	1.75	1.25	1	0.42	0.46	0.40	0.51	7.9	6.00	16
\$EN	CW	Marb	REA	Fat	\$M	\$W	\$F	\$G	\$B	\$C	\$AxH	\$AxJ		
-30	66.00	0.78	0.71	-0.033	39	61	106	64	170	259	147	138		

148 YW EPD and a top 15% \$B!

Lot 20 EXAR FUNDAMENTAL 2660B +20289067
 100% AN POLLED
 Calved 1/18/2022 Consigned by: Express Ranch
 Tattoo 2660B Yukon, Ok.

Basin Payweight 1682 Act BW
 Deer Valley Growth Fund 80
 Deer Valley Rita 36113 Adj WW
 EXAR Fundamental 9186B 734
 EXAR Upshot 0562B Adj YW
 EXAR Royal Lass 4639 1308
 EXAR Royal Lass 1067 Adj Yrlg SC
 37
 Plainview Luton E102 Adj IMF
 S&R Roundtable J328 5.85
 PVF Proven Queen 786 5.85
 EXAR Envious Blackbird 1568 Adj REA
 PVF Insight 0129 16.20
 EXAR Envious Blackbird 2215 Adj Fat
 EXAR Envious Blackbird 2611 0.33

CED	BW	WW	YW	RADG	DMI	SC	Doc	Claw	Angle	PAP	HS	HP	CEM	Milk
1.00	3.8	75	121	0.25	0.73	0.31	23	0.45	0.42	0.41	0.96	6.2	5.00	27
\$EN	CW	Marb	REA	Fat	\$M	\$W	\$F	\$G	\$B	\$C	\$AxH	\$AxJ		
-10	49.00	0.60	0.69	0.030	68	70	89	50	138	247	122	98		

Scanned a 16.2 inch ribeye!

Lot 18 EXAR JET FUEL 2087B 20301065
 100% AN POLLED
 Calved 1/31/2022 Consigned by: Express Ranch
 Tattoo 2087B Yukon, Ok.

Connealy Black Granite Act BW
 Bar R Jet Black 5063 71
 Bar R Iris Anita 0113 Adj WW
 EXAR Jet Fuel 9706B 780
 Sitz Top Game 561X Adj YW
 EXAR Lucy 5727 1388
 EXAR Lucy 0901 Adj Yrlg SC
 39
 V A R Discovery 2240 Adj IMF
 EZAR Gold Rush 6001 7.66
 V A R Blackcap 1059 7.66
 EXAR Pride 9048 Adj REA
 EXAR Upshot 0562B 13.80
 EXAR Pride 4429 Adj Fat
 KLR Madame Pride 0017 0.38

CED	BW	WW	YW	RADG	DMI	SC	Doc	Claw	Angle	PAP	HS	HP	CEM	Milk
8.00	1.6	77	141	0.30	1.78	1.11	21	0.71	0.54	1.27	0.89	9.6	12.00	23
\$EN	CW	Marb	REA	Fat	\$M	\$W	\$F	\$G	\$B	\$C	\$AxH	\$AxJ		
-42	48.00	1.06	0.56	-0.028	34	62	79	76	155	235	116	93		

Scanned 7.66% IMF and has calving ease and added growth built into his pedigree.

Lot 21 EXAR FUNDAMENTAL 2650B 20262277
 100% AN POLLED
 Calved 1/14/2022 Consigned by: Express Ranch
 Tattoo 2650B Yukon, Ok.

Basin Payweight 1682 Act BW
 Deer Valley Growth Fund 88
 Deer Valley Rita 36113 Adj WW
 EXAR Vanguard 0614B 819
 3F Epic 4631 Adj YW
 EXAR Rita 0896 1358
 EXAR Rita 3717 Adj Yrlg SC
 37
 Connealy Consensus 7229 Adj IMF
 V A R Generation 2100 4.97
 Sandpoint Blackbird 8809 4.97
 Deer Valley Henrietta 6706 Adj REA
 Connealy Onward 14.40
 Sitz Henrietta Pride 643T Adj Fat
 Sitz Henrietta Pride 81M 0.36

CED	BW	WW	YW	RADG	DMI	SC	Doc	Claw	Angle	PAP	HS	HP	CEM	Milk
-6.00	5.2	89	147	0.27	1.58	0.18	19	0.53	0.48	3.59	0.91	9.3	0.00	28
\$EN	CW	Marb	REA	Fat	\$M	\$W	\$F	\$G	\$B	\$C	\$AxH	\$AxJ		
-30	73.00	0.42	0.87	0.027	55	74	108	43	151	251	84	80		

Vanguard sons are the Definition of Power! They are deep, thick and have a great deal of rib.

Lot 22 EXAR CONTINUITY 2951 20276637
100% AN POLLED
 Calved 2/05/2022 Consigned by: Express Ranch
 Tattoo 2951-HR Yukon, Ok.

Mohnen Substantial 272 Act BW
 Sitz Profile 1160 66
 SITZ Blackbird 334 Adj WW
 Sitz Continuity 679
 SITZ Logo 12964 Adj YW
 Sitz Erica Everelda 2007 1313
 Sitz Erica Everelda 2655 Adj Yrlg SC
 39
 Poss Achievement Adj IMF
 Sitz Accomplishment 720F 3.50
 Sitz Barbaramere Nell 166D
 Sitz Eisa Evergreen 660 Adj REA
 Spring Cove Paygrade 5064 15.30
 Sitz Eisa Evergreen 3238 Adj Fat
 SITZ Eisa Evergreen 3302 0.36

CED	BW	WW	YW	RADG	DMI	SC	Doc	Claw	Angle	PAP	HS	HP	CEM	Milk
7.00	1.6	75	131	0.27	1.33	1.20	20	0.39	0.48	0.42	0.59	18.4	9.00	35
\$EN	CW	Marb	REA	Fat	\$M	\$W	\$F	\$G	\$B	\$C	\$AxH	\$AxJ		
-15	54.00	0.62	0.89	0.012	95	81	89	55	144	282	142	125		

An out-cross breed bull for most Express Ranch customers. His dam is the high \$M, High maternal daughter of Sitz Accomplishment that Express Ranches has flushed extensively.

Lot 23 EXAR FUNDAMENTAL 7021B 20159955
100% AN POLLED
 Calved 10/17/2021 Consigned by: Express Ranch
 Tattoo 7021B Yukon, Ok.

Basin Payweight 1682 Act BW
 Deer Valley Growth Fund 76
 Deer Valley Rita 36113 Adj WW
 EXAR Fundamental 9186B 595
 EXAR Upshot 0562B Adj YW
 EXAR Royal Lass 4639 1045
 EXAR Royal Lass 1067 Adj Yrlg SC
 37
 S A V Final Answer 0035
 SandPoint Butkus X797 Adj IMF
 G A R Grid Maker 4603 3.38
 PF Henrietta Pride 5010 Adj REA
 Connealy Onward 13.50
 Sitz Henrietta Pride 643T Adj Fat
 Sitz Henrietta Pride 81M 0.21

CED	BW	WW	YW	RADG	DMI	SC	Doc	Claw	Angle	PAP	HS	HP	CEM	Milk
6.00	1.1	84	113	0.28	0.70	1.33	19	0.44	0.37	1.15	0.77	10.5	9.00	17
\$EN	CW	Marb	REA	Fat	\$M	\$W	\$F	\$G	\$B	\$C	\$AxH	\$AxJ		
-11	29.00	0.24	0.55	0.002	60	54	71	32	102	192	68	30		

Fundamental sons are rugged and have more bone and foot size.

Lot 24 BK PRIMO 6101K AAA20509847
 Calved 03/13/2022 Consigned by: Jirl Buck
 Tattoo 610K Madill, Ok.

DAMERON FIRST CLASS AAA *16175085
COLBURN PRIMO 5153 AAA +*18217480 [RDF]
 SILVEIRAS SARAS DREAM 1339 AAA+*16987763

CTS REMEDY 1T01 AAA #*17331233 [RDF]
EA MADAME PRIDE 6101 AAA *18542947
 EA MADAME PRIDE 4106 AAA #*17933314

EPDS: CED +3, BW +1.2, WW +48, YW +84, Milk +17.

Lot 25 SN TUITION 155 AAA 20777755
 Calved 12/21/2021 Consigned by: Shay Navia
 Tattoo 155 Deport, Tx.

PA VALOR 201 AAA #+*17326601
RUGGLES McCOOK 9530 AAA 18875307
 MILL BAR McHENRY BIKCAP 7676 AAA 18183010

MILL BAR WENT STELLAR 6221 AAA *16743050
ECHOLS MOONBEAM 305 AAA 17536862
 ECHOLS MOONBEAM 1032 AAA 16722113

In 2018, Shay Navia was a recipient of the Chamber of Commerce Bull Sale Scholarship. After graduating from Tarleton State University, she is currently a second year student in Occupational Therapy at University of Texas Medical Branch Galveston. She plans on returning home and working in Lamar County when she receives her PhD. She runs several cows with her family. This bull, aptly named Tuition, is the result of 6 generations of Angus cattle developed in Northeast Texas.
 EPDS: CED +5, BW +2.4, WW +72, YW +128, Milk +26.

**From the Staff of the Lamar County Chamber of Commerce
 and the Agriculture Committee**

**Thank you to our sponsors whose ads you see included in this catalog.
 Due to our generous sponsors, printing costs for this catalog has been covered.
 We also say "thank you" to the contributors and purchasers of baked goods,
 we appreciate your contribution.**

**Most of all, to the consignors and buyers at this sale we say a huge
 "THANK YOU", this event could not happen without you.**

GLASS LAND & HOME

YOUR FARM AND RANCH SPECIALIST!
SERVING NE TEXAS AND SOUTHEAST
OKLAHOMA!

BRYAN GLASS, BROKER

glasslandandhome.com

903-785-8457

2407 Lamar Ave. Ste A

Paris, TX 75460



**GLASS
LAND & HOME**

BRANGUS

Black Brangus Breed EPD Averages- October 2023

	CE	BW	WW	YW
Active Sire	4.94	.046	23.10	44.74

MAT	CE	TM	SC	Milk	IMF	RE	Fat
3.53	19.93	.568	8.70	.075	.199	.0039	

Lot 34 PB STONEWALL 1461 R10504881

POLLED

Calved 04/20/2021
Tattoo 1461 LE

Consigned by: Patterson Brangus
Brookston, Tx.

STONEWALL OF RRR 222W6 R10150860 [PV]
PB STONEWALL 758 R10406165
PB MS AVALANCHE 1304 R10254010

PB STAR 2132 R10232862
PB MS STAR 1487 R10370000
PB MS AVALANCHE 2161 R10208975

EPD's: CE 5.3, BW .0, WW 17, YW 32, Milk 6, TOT MAT 15.

Lot 31 PB STONEWALL 141 R10504893

POLLED

Calved 05/05/2021
Tattoo 141 LE

Consigned by: Patterson Brangus
Brookston, Tx.

STONEWALL OF RRR 222W6 R10150860 [PV]
PB STONEWALL 758 R10406165
PB MS AVALANCHE 1304 R10254010

W&WB AVALANCHE 11/T R10107103
PB MS AVALANCHE 1857 R10370012
PB MS ANGELO 5130 R10184217

EPD's: CE 2.7, BW 1.2, WW 17, YW 31 Milk 9, TOT MAT 17.

Lot 35 PB STONEWALL 892 R10521357

POLLED

Calved 03/02/2022
Tattoo 892 LE

Consigned by: Patterson Brangus
Brookston, Tx.

STONEWALL OF RRR 222W6 R10150860 [PV]
PB STONEWALL 758 R10406165
PB MS AVALANCHE 1304 R10254010

PB STAR 2132 R10232862
PB MS STAR 1219 R10445292
PB MS AVALANCHE 2180 R10184208

EPD's: CE 5.3, BW .0, WW 17, YW 32, Milk 6, TOT MAT 15.

Lot 32 PB STONEWALL 1361 R10492731

POLLED

Calved 03/12/2021
Tattoo 1361 LE

Consigned by: Patterson Brangus
Brookston, Tx.

STONEWALL OF RRR 222W6 R10150860 [PV]
PB STONEWALL 758 R10406165
PB MS AVALANCHE 1304 R10254010

W&WB AVALANCHE 11/T R10107103
PB MS EBONY 1768 R10393439
PB MS STAR 1305 R10254011

EPD's: CE 5.3, BW 0.6, WW 14, YW 28, Milk 7, TOT MAT 14.

Lot 36 PB STONEWALL 1401 R10492718

POLLED

Calved 03/10/2021
Tattoo 1401 LE

Consigned by: Patterson Brangus
Brookston, Tx.

STONEWALL OF RRR 222W6 R10150860 [PV]
PB STONEWALL 758 R10406165
PB MS AVALANCHE 1304 R10254010

W&WB AVALANCHE 11/T R10107103
PB MS AVALANCHE 1301 R10254007
PB MS PINE 21103 R9668759

EPD's: CE 6.4, BW -0.1, WW 19, YW 33 Milk 9, TOT MAT 18.

Lot 33 PB DUKE 871 R10492725

POLLED

Calved 03/21/2021
Tattoo 871 LE

Consigned by: Patterson Brangus
Brookston, Tx.

WR DUKE 661S8 R10093896 [PV]
DMR DUKE 3241X5 R10189849
MS DMR NEWT 3241U R10139808

W&WB CLASSIC STAR 20/U1 R10101722
PB MS STAR 1308 R10254014
PB MS AVALANCHE 3031 R10208985

EPD's: CE 3.5, BW 0.4, WW 17, YW 32 Milk 10, TOT MAT 19.

Lot 37 PB SUNDANCE 1362 R10504911

POLLED

Calved 11/20/2021
Tattoo 1362 LE

Consigned by: Patterson Brangus
Brookston, Tx.

SUNDANCE OF BRINKSX 24Z2 R10273233
DDBAR BRINKS SUNDANCE 796C R10331126
MS BRINKS SONAR 796T R10083423

W&WB AVALANCHE 11/T R10107103
PB MS AVALANCHE 1186 R10339324
PB MS ANGELO 5050 R10184216

EPD's: CE 3.8, BW 0.4, WW 15, YW 32, Milk 11, TOT MAT 19.

<p>Lot 38 PB STONEWALL 1411 R10492728 POLLED</p> <p>Calved 03/24/2021 Tattoo 1411 LE</p> <p>Consigned by: Patterson Brangus Brookston, Tx.</p> <p>STONEWALL OF RRR 222W6 R10150860 [PV] PB STONEWALL 758 R10406165 PB MS AVALANCHE 1304 R10254010</p> <p>W&WB CLASSIC STAR 20/U1 R10101722 PB MISS STAR 1362 R10267032 PB MS AVALANCHE 2491 R10197080</p> <p>EPD's: CE 7.3, BW -0.3, WW 14 YW 28, Milk 6, TOT MAT 13.</p>	<p>Lot 42 MS GUNS SPECIAL R10540875</p> <p>Calved 05/05/2021 Tattoo 594J</p> <p>Consigned by: Phil Smith Roxton, Tx.</p> <p>333Y8-MC SOMETHING SPECIAL 333Y8 R10201658 [SV] 89W2A - SOMETHING SPECIAL 89 R10289908 89W2 - SF MISS EL ELEVEN 89W2 R10139701</p> <p>124R - MC GUNS DONOVAN 124R R10020242 MC MS GUNS 594Y R10201074 594S - MC MS NEW DIRECTION 594S R10069761</p> <p>This bull has a great disposition, plenty of volume and bone mass, has been on grass and will stay hard developed and won't fall apart. EPD's: CE 1.9, BW 1.6, WW 22, YW 42, Milk 5.</p>
<p>Lot 39 SF SPECIAL R10540877</p> <p>Calved 05/04/2021 Tattoo 94J</p> <p>Consigned by: Phil Smith Roxton, Tx.</p> <p>333Y8-MC SOMETHING SPECIAL 333Y8 R10201658 [SV] 89W2A - SOMETHING SPECIAL 89 R10289908 89W2 - SF MISS EL ELEVEN 89W2 R10139701</p> <p>333Y8 - MC SOMETHING SPECIAL 333Y8 R10201658 [SV] 94C - SF94C0303 R10314813 94W - TBF MS BRINKS BLACKHAWK 94W R10136321</p> <p>This bull has a great disposition, plenty of volume and bone mass, has been on grass and will stay hard developed and won't fall apart. EPD's: CE 3.2, BW 1.6, WW 24, YW 48, Milk 9.</p>	
<p>Lot 40 CONVERSION SPECIAL UB10540876</p> <p>Calved 05/08/2021 Tattoo 6449J</p> <p>Consigned by: Phil Smith Roxton, Tx.</p> <p>333Y8-MC SOMETHING SPECIAL 333Y8 R10201658 [SV] 89W2A - SOMETHING SPECIAL 89 R10289908 89W2 - SF MISS EL ELEVEN 89W2 R10139701</p> <p>889Z20- MC CONVERSION 889Z20 R10228546 [PV] 6449C10 -MC MS CONVERSION 6449C10 UB10306051 [SV] 6449 - DATELINE OF CONANGA 6449L EA13961193</p> <p>This bull has a great disposition, plenty of volume and bone mass, has been on grass and will stay hard developed and won't fall apart. EPD's: CE 4.1, BW 1.2, WW 19, YW 35, Milk 7.</p>	
<p>Lot 41 BRINKS SPECIAL R10540874</p> <p>Calved 05/16/2021 Tattoo 415J</p> <p>Consigned by: Phil Smith Roxton, Tx.</p> <p>333Y8-MC SOMETHING SPECIAL 333Y8 R10201658 [SV] 89W2A - SOMETHING SPECIAL 89 R10289908 89W2 - SF MISS EL ELEVEN 89W2 R10139701</p> <p>129X12 - MC JETHRO 129X12 R10177545 415Z - CHARLOTTE OF BRINKS R10237058 415P43 -MS BRINKS TRACKER 415P43 R9693678</p> <p>This bull has a great disposition, plenty of volume and bone mass, has been on grass and will stay hard developed and won't fall apart. EPD's: CE 3.0, BW 1.6, WW 18, YW 39, Milk 8.</p>	

BEEFMASTER

Beefmaster Breed EPD Averages - Fall 2023

	BW	WW	YW	Milk	SC	CE
Active Sires	0.1	21.1	36.6	9.5	0.3	3.4
MCE	MW	RFI	Marb	REA	Fat	
3.1	20.0	0.0	0.0	0.1	0.0	

Lot 45 **CBF 9/22** **C1172873**
 POLLED **RED PAINT STAR FACE**
 Calved 02/20/2022 Consigned by: Curtis & Barbara Fendley
 Tattoo 9/22 L/HIP Paris, Tx.

LASATER 361 361 LH C1061893
CF 9/96 9/96 LH **C1120515**
 156 LH C1069852

CG 2852 2852 RE C1024764
7/15 RH **C1064481**
 5/10 RH C1055716

EPD's: CE 3.4, BW 0.3, WW 16.0, YW 36.1, Milk 10.2.

Lot 43 **DIAMONDT 264** **C1158625**
 LIGHT RED **POLLED**
 Calved 03/11/2022 Consigned by: Diamond T Ranch
 Tattoo 264 L/HIP

5050 RE HENNEGIN'S C1059116
906 RE HENNEGIN'S **C1118935**
 956 LH C.R.I.B. CREEK C986379

MULTIPLE SIRE MS
CASEY 6-164 6-164 LH CASEY **C1094582**
 CASEY 1-28 1-28 LH CASEY C1022163

Actual BW 70#, Actual WW 553#
 Good disposition polled bull. Won't melt when you turn him out.
 EPD's: CE 3.2, BW 0.0, WW 23.4, YW 43.5, Milk 10.5.

Lot 45 - A **CBF 10/22** **C1172874**
 POLLED **RED MOTTLE UNDERLINE**
 Calved 02/21/2022 Consigned by: Curtis & Barbara Fendley
 Tattoo 10/22 R/HIP Paris, Tx.

CAPTAIN 417 LH C1050196
749 LH **C1098139**
 016 LH C1004625

CG 2852 2852 RE C1024764
2/15 RH **C1064476**
 5/8 LH C980759

EPD's: CE 3.0, BW 0.7, WW 24.5, YW 46.6, Milk 13.5.

Lot 44 **CBF 9/21** **C1161743**
 POLLED **BLACK**
 Calved 07/05/2021 Consigned by: Curtis & Barbara Fendley
 Tattoo 9/21 L/HIP Paris, Tx.

SCHNEIDER 0481 0481 LH C994584
HOOD 576 576H LE **C1067555**
 MS HOOD 726 H726 LE S23502

3/4 LH C923257
6/7 LH **C959076**
 WINNIE 94 RH C799784

EPD's: CE 4.5, BW -0.4, WW 15.2, YW 36.4, Milk 10.7.

Lot 45 - B **CBF 11/22** **C1172875**
 POLLED **BLACK**
 Calved 03/01/2022 Consigned by: Curtis & Barbara Fendley
 Tattoo 11/22 L/HIP Paris, Tx.

507 LH C1061410
923 LH **C1117821**
 5125 LH C1063564

COCHESI 126 LH C935975
ESTRELLA 5/12 RH **C1055266**
 32/4 LH C893019

EPD's: CE 3.1, BW 0.4, WW 17.2, YW 34.0, Milk 9.6.

Meet our very own
GiGi



Born naturally with the Guaranty G on her right shoulder, GiGi has become part of the Guaranty Family. GiGi is owned by our very own Director of Human Resources, Deann Crooks.

Paris
3250 Lamar Ave | 903.784.4100
2015 NE Loop 286 | 903.783.7010

Member FDIC | www.gnty.com

Guaranty
Bank & Trust

110

CHAROLAIS

Charolais Breed EPD Averages - September 2023

	CE	BW	WW	YW	Milk	MCE	MTL
Active Sire	10.1	-1.1	61.0	109.8	23.6	8.6	54.1

SC	UDDER	TEAT	CW	Marb	REA	Fat	TSI
1.0	1.08	1.08	16.7	0.10	0.61	0.004	253.06

Lot 46 **LITTLEMAN** **M965210**
 POLLED
 Calved 10/07/2021 Consigned by: Cook Cattle, LLC
 Tattoo 1(LE) Shreveport, La.

388 RH POLLED M876477
MR LEDGER 218LE POLLED **M898297**
 GC MISS MILEY INXS 460 POLLED F1201357

 HEP SIR DUKE 21Y POLLED M815388
HEP MISS JOAN 3B POLLED **F1188377**
 HEP MISS JOAN 4W POLLED F1104262

A nice gentle Mr. Ledger son carrying the same body type as his Dad.
 That is , Low birth weight, rapid WW, and a nice deep body. Check him
 out.
 EPDS: CE 4.8, BWT 0.8, WWT 58, YWT 104, Milk, 19, MCE 6.3, MTNL 48.

Lot 47 **GREER 2** **M965211**
 POLLED
 Calved 10/07/2021 Consigned by: Cook Cattle, LLC
 Tattoo 2(LE) Shreveport, La.

388 RH POLLED M876477
MR LEDGER 218LE POLLED **M898297**
 GC MISS MILEY INXS 460 POLLED F1201357

 LT LEDGER 0332 POLLED M791626
BAMBOO MS LEDGER 7341 POLLED **F1241080**
 BAMBOO MS IMPRESSIVE 5512ET EF 1206396
 POLLED

A low birth weight with good milking EPDs. Home raised, fed
 daily by an 89 year old man. Gentle is the word.

EPDS: CE 7.0, BWT -0.5, WWT 53, YWT 99, Milk, 19, MCE 6.6, MTNL 45.

Lot 48 **SAINT 3** **M965212**
 POLLED
 Calved 10/08/2021 Consigned by: Cook Cattle, LLC
 Tattoo 3(LE) Shreveport, La.

388 RH POLLED M876477
MR LEDGER 218LE POLLED **M898297**
 GC MISS MILEY INXS 460 POLLED F1201357

 FH-DCF COWBOY 219 P ET POLLED EM832257
DCF IMPRESSIVE 539C POLLED **F1221346**
 DCF MS IMPRESSIVE 577P POLLED F1024792

A nice moderate framed bull out of Mr. Ledger.

EPDS: CE 6.5, BWT 0.8, WWT 53, YWT 92, Milk, 26, MCE 6.1, MTNL 53.

Lot 49 **MRRH** **M965215**
 POLLED
 Calved 10/18/2021 Consigned by: Cook Cattle, LLC
 Tattoo 6(LE) Shreveport, La.

388 RH POLLED M876477
MR LEDGER 218LE POLLED **M898297**
 GC MISS MILEY INXS 460 POLLED F1201357

JDJ RESOURCE Z365 POLLED M826959
BC LADY RESOURCE C26 PLD DEHORND **F1215416**
 BC MS E46 DUKE X38 PET POLLED EF1131719

Big and thick shown here!

EPDS: CE 5.9., BWT -0.1, WWT 51, YWT 95, Milk, 24, MC 5.7, MTNL 49.

Lot 50 **MR BIGGS** **M965215**
 POLLED
 Calved 10/18/2021 Consigned by: Cook Cattle, LLC
 Tattoo 7(LE) Shreveport, La.

388 RH POLLED M876477
MR LEDGER 218LE POLLED **M898297**
 GC MISS MILEY INXS 460 POLLED F1201357

JDJ RESOURCE Z365 POLLED M826959
BC LADY RESOURCE C26 PLD DEHORND **F1215416**
 BC MS E46 DUKE X38 PET POLLED EF1131719

Nice young Ledger son that shows good yearling weight.

EPDS: CE 5.1, BW 0.0, WW 45, YW 87, Milk 19, TSI 230.87.

Lot 51 **MR STRETCH K248** **M985581**
 POLLED
 Calved 02/15/2022 Consigned by: Stretcher Charolais
 Tattoo K248(LH) Mt. Vernon, Tx., previously JFS Ranch

M6 BELLS & WHISTLES 586 POLLED M859102
RC B&W586 470P **POLLED** **M924723**
 RC MS BIG TOPI 389 DEHORND F1087995

BAMBOO LEDGER OF F216 2323ET POL M833396
BAMBOO MS LEDGER 6314 POLLED **F1226228**
 BAMBOO DAISY 3347 POLLED F1187660

K248 is a smooth bull with a clean front end for easy calving and has
 the EPD's for calves smashing the scales. Dam is out of Ledger and
 Grid Maker.

Actual BW 84 lbs.

EPDS: CE 11.2, BW -0.9, WW 59, YW 103, Milk 20, MCE 6.8, TSI 246.46.

Lot 52 **MR STRETCH K245** **M985578**
 POLLED
 Calved 03/06/2022 Consigned by: Stretcher Charolais
 Tattoo K245(LH) Mt. Vernon, Tx., previously JFS Ranch

M6 BELLS & WHISTLES 586 POLLED M859102
RC B&W586 470P **POLLED** **M924723**
 RC MS BIG TOPI 389 DEHORND F1087995

TEL BLUE BOY 1403 POLLED M844522
TEL GRACIELLA D15 POLLED **F1223301**
 TEL MS MAC 371 POLLED F1075175

K245 has a big top and is built for the commercial cattleman or
 registered breeder. If you are going to be in the cattle business and
 need a bull look no more. (M6 Bells & Whistles, TEL Blue Boy, LT
 Bluegrass

Actual BW 80 lbs.

EPDS: CE 9.1, BW -0.9, WW 45, YW 82, Milk 20, MCE 7.3, TSI 226.55.



We have dedicated staff with years of experience in agricultural production and specialized risk and insurance programs for your farm, ranch, and commercial agricultural operations. Call us today!

Curtis Fendley, CIC

Clifton Fendley, CIC

Claudia Fendley-Middleton

Cindy Morton

Russell Jackson, CLU

(903) 784-0836

1705 Lamar Ave
Paris, TX 75460

419 N. Main St
Bonham, TX 75418

108 W. Front St
DeKalb, TX 75559

<p>Lot 53 BA GHOST RIDER 751 M972270 POLLED</p> <p>Calved 02/17/2022 Consigned by: Bar A Charolais Tattoo K217 Howe, Tx.</p> <p>BJR HANK 984 P M784271 NC/MW HANK 751 TW M905615 NC SWEETHEART 309P F1173057</p> <p>AC MR PERFECT DUKE 612 M733254 KS MISS RUTH ANN F1157559 KS MISS TESS ELIMINATOR F804904</p> <p>This bull has been developed on native pasture and protein when needed. The way we develop our bulls they will not fall apart, because we do not push the feed to them, we let them grow.</p> <p>EPDS: CE 8.4., BW 1.1, WW 55, YW 95, Milk, 20, MC 10.0, MTNL 47.</p>	<p>Lot 55 GWT BAYVUE TURTON 3221 M987518 POLLED</p> <p>Calved 03/08/2022 Consigned by: Bayvue Farms Tattoo 3221(RE) Bay, Mo.</p> <p>TR MR FIRE WATER 5792RET EM704588 TR PZC MR TURTON 0794 ET EM790987 THOMAS MS IMPRESSIVE0641 F873178</p> <p>M&M OUTSIDER 4003 PLD M846631 BOY MOLLY 904 ET PLD EF1278605 D&D MS COVERGIRL 1516 PLD F1204817</p> <p>3221 has a small cloud in his right eye from something. It doesn't affect sight at all. He is a performance bull with a lot of eye appeal. This is a bull that can produce pounds in a desirable package. Actual BW 89#, WW 695#, YW 1150#. EPDS: BW -1.1, WW 58, YW 103, Milk 28.</p>
<p>Lot 54 BA WHITEMAN 751 M972269 SCURS</p> <p>Calved 04/26/2022 Consigned by: Bar A Charolais Tattoo K426 Howe, Tx.</p> <p>BJR HANK 984 P M784271 NC/MW HANK 751 TW M905615 NC SWEETHEART 309P F1173057</p> <p>MBS LEDGER 353 M831604 KS MISS DAISY F1236199 AC MS CIGAR 016 F1137177</p> <p>This bull has been developed on native pasture and protein when needed. The way we develop our bulls they will not fall apart, because we do not push the feed to them, we let them grow.</p> <p>EPDS: CE 8.9, BWT 0.6, WWT 65, YWT 109, Milk 23, MCE 10.1, MTL 55.</p>	<p>Lot 56 BAYVUES SIGNATURE 012 P M987916 POLLED</p> <p>Calved 01/01/2022 Consigned by: Bayvue Farms Tattoo 012 (RE) Bay, Mo.</p> <p>LT SUNDANCE 2251 PLD M820210 BAYVUES WAR DANCER 195P M907178 BAYVUE'S 023 316 P F1048432</p> <p>DC POMONIA GRID C903P M774375 WH KAYLEE 139 PLD F1153214 WH VICKEY 919 F1119632</p> <p>This is a bull with Lots of Thickness and desirable traits. Our Signature Line of cattle go back to Bayvues 023 316P, the cow that has produced 4 herd bulls for us. Problem free and consistent in Quality and Performance. 012 is a complete offering that represents the best and most predictable genetics we have. Actual BW 76#, WW 875#, YW 1312#. EPDS: BW 1.2, WW 63, YW 113, Milk 23, TSI 253.</p>
	<p>Lot 57 GWT BAYVUE OAK OUTKAST 3212 M987511 SCURS</p> <p>Calved 02/28/2022 Consigned by: Bayvue Farms Tattoo 3212 (RE) Bay, Mo.</p> <p>M&M OUTSIDER 4003 PLD M846631 TR MR OUTKAST 6605D M879418 TR MS DIABLO 3631A F1172511</p> <p>GWT BUCKSHOT 2300 M846717 GWT LIL PRINCESS F1302888 GWT CAMILLA ANDI 2378 F2141742</p> <p>This is a smaller framed bull with tremendous thickness and eye appeal. If you want to raise show calves out of your eared cattle, look at this guy. Sired by TR Mr Outkast a National Champion bull. RDE Sire and cattle that will knock your eyes out good!!</p> <p>Actual BW 85#, WW 588#, YW 1075#. EPDS: BW -0.6, WW 51, YW 89, Milk 18, TSI 228.</p>

BUILDING

LONGSTANDING

RELATIONSHIPS

"It's a real comfortable fit with Lone Star, they are able to address our needs and concerns and really work closely with us. They know how things are going throughout the year and can accommodate our needs."

ROLAN PETTY | RR RANCH
Member Since 1982

FINANCING FOR:
RURAL REAL ESTATE | RURAL HOMES
FARM OR RANCH OPERATIONS
EQUIPMENT | AGRIBUSINESSES
RECREATIONAL PROPERTY

Visit [LoneStarAgCredit.com](https://www.LoneStarAgCredit.com) to
connect with a loan officer near you.

LONE  STAR
AG CREDIT

FINANCING YOUR PIECE OF TEXAS



Lot 58 SRB GERARD 2K27 P M985628 POLLED Calved 03/04/2022 Consigned by: Bailly O Braun Tattoo 2K27 (LE) Jefferson, Mo. TR PZC MR TURTON 0794 ET PLD EM790987 WIA-CONLEY INSIDER D9 POLLED EM881298 M&M MS CARBINE 1567 PLD F1151854 BF MR DUKE C927 POLLED EM879054 JSF MS MACY F122 POLLED F1253633 JSF GRID'S MACY 9122 PLD F1164186 Actual BW 95 lbs., WW 689 lbs. EDPS: BW 0.5, WW 61, YW 104, MILK 22.	Lot 62 RDG MR TEXAS PRIDE 3 M985121 DEHORND Calved 01/28/2022 Consigned by: Robert Gaston Tattoo 3(RE) Canton, Texas VALIANT JR-E03 M49796 MR E03 IMAGE G178 DEHORND AFM904440 MS AMERICANA FRENCHIE DEHORND F1207500 GWM TEXAS HERITAGE DEHORND FFM852287 MS TEXAS HERITAGE 318 DEHORND FFF1286748 MS ROCKY OBBDO 406 DEHORND FFF1075522 EDPS: CE 4.5, BW 1.5, WW 47, YW 79, MILK 10, MCE 8.2, MTNL 33.
Lot 59 SRB CALVIN 2K28 P M985627 POLLED Calved 03/04/2022 Consigned by: Bailly O Braun Tattoo 2K28 (LE) Jefferson, Mo. TR PZC MR TURTON 0794 ET PLD EM790987 WIA-CONLEY INSIDER D9 POLLED EM881298 M&M MS CARBINE 1567 PLD F1151854 RF LEDGER 439 POLLED M855024 RF MS CLARICE 672 POLLED F1259832 WIA MS INDIAN EDGE PLD F1149128 Actual BW 85 lbs., WW 495 lbs. EDPS: BW -2.7, WW 58, YW 99, MILK 14.	Lot 63 RDG MR TEXAS PRIDE 4 M985122 DEHORND Calved 05/04/2022 Consigned by: Robert Gaston Tattoo 3(RE) Canton, Texas MR E03 IMAGE G178 DEHORND AFM90440 MR E03 IMAGE 919 HORND M966706 MS TEXAS HERITAGE 1118 DEHORND FFF1286755 OBBDO HIGH HOPE H24 DEHORND FFM907465 MS MARQUIS 2219 POLLED FFF1289178 MISS TEXAS HERITAGE RDG 1015 DEHORND FFF1234310 EDPS: CE 2.6, BW 2.2, WW 47, YW 83, MILK 12, MCE 6.5, MTNL 36.
Lot 60 SRB MONTFORD 2K29 P M985629 POLLED Calved 03/11/2022 Consigned by: Bailly O Braun Tattoo 2K29 (LE) Jefferson, Mo. CML DIABLO 2X POLLED M802033 TR MR DIABLO 2742Z ET SCURS EM830595 HF MUSTANG SALLY 904 PLD F1104171 LT LEDGER 0332 P POLLED M791626 WIA MS LEDGER P E42 POLLED F1241771 MC MISS O'SILVER 3132 PLD F1222182 Actual BW 103 lbs., WW 567 lbs. Has a bigger birth wt then 2K28 and 2K27, but is out of a bull with a -2.6 BW and a 17.3 CE, will calve easy. EDPS: BW 0.8, WW 45, YW 95, MILK 22.	Lot 64 WHEAT MR. FLASH 1-10 M988364 POLLED Calved 09/05/2021 Consigned by: Wheatcraft Farms Tattoo 1-10 LE Brookfield, Mo. ONE PENNY BLANCO FLASH 6424 M731925 JCR FLASH 721 P M895289 JCR BLUEGRASS 283 P F1153738 MEAD LEDGER P281 M862255 WHEATCRAFT MISS LEDGER 8-200 F1277839 SILVER NUGGET 7-125 F1075871 EDPS: CE 9.0, BW 0.1, WW 55, YW 105, MILK 20.
Lot 61 RDG MR TEXAS PRIDE 6 M985145 DEHORND Calved 05/01/2022 Consigned by: Robert Gaston Tattoo 2K29 (LE) Canton, Tx. MR E03 IMAGE G178 DEHORND AFM904440 MR E03 IMAGE 919 HORND M966706 MS TEXAS HERITAGE 1118 DEHORND FFF1286755 MC MISS O'SILVER 3132 PLD F1222182 GWM TEXAS HERITAGE DEHORND FFM852287 MISS TEXAS HERITAGE 417 DEHORND FFF1251177 MS RDG 49 HORND FFF1116183 EDPS: CE 6.1, BW 0.7, WW 45, YW 81, MILK 13, MCE 8.3, MTNL 36.	Lot 65 WHEAT MR. FLASH 1-12 M988365 POLLED Calved 09/05/2021 Consigned by: Wheatcraft Farms Tattoo 1-12 LE Brookfield, Mo. ONE PENNY BLANCO FLASH 6424 M731925 JCR FLASH 721 P M895289 JCR BLUEGRASS 283 P F1153738 WHEATCRAFT MISS LEDGER 8-202 F1277529 SILVER NUGGET 7-255 F1086496 EDPS: CE 9.0, BW -0.1, WW 49, YW 96, MILK 20.

<p>Lot 66 WHEAT MR. SUPREME DRAFT 1-18 M988366 WHITE POLLED Calved 09/10/2021 Consigned By: Wheatcraft Farms Tattoo 1-18 LE Brookfield, Mo.</p> <p>CML DRAFT PICK 436B EM866472 WELLS MR SUPREME DRAFT 748 M897487 GCR MISS T48 F1143689</p> <p>MEAD LEDGER P300 M862271 WHEATCRAFT MIS LEDGER 7-290 F1260287 SILVER NUGGET 2-50 F1165550</p> <p>EPD's: CE 10.6, BW 0.3, WW 41, YW 78, Milk 20.</p>	<p>Lot 70 WHEAT MR FLASH 1-226 M988487 WHITE POLLED Calved 09/15/2021 Consigned By: Wheatcraft Farms Tattoo 1-226 LE Brookfield, Mo.</p> <p>CML DRAFT PICK 436B EM866472 WELLS MR SUPREME DRAFT 748 M897487 GCR MISS T48 F1143689</p> <p>MEAD LEDGER P281 M862255 WHEATCRAFT MISS LEDGER 7-250 F1260282 SILVER NUGGET 2-46 F1165535</p> <p>EPD's: CE 9.5, BW 0.3, WW 55, YW 92, Milk 20.</p>
<p>Lot 67 WHEAT MR. SUPREME DRAFT 1-220 M988484 WHITE POLLED Calved 09/11/2021 Consigned By: Wheatcraft Farms Tattoo 1-220 LE Brookfield, Mo.</p> <p>CML DRAFT PICK 436B EM866472 WELLS MR SUPREME DRAFT 748 M897487 GCR MISS T48 F1143689</p> <p>MEAD LEDGER P281 M862255 MISS WHEATCRAFT LEDGER 7-215 F1260192 SILVER NUGGET 2-13 F1165524</p> <p>EPD's: CE 10.0, BW 0.6, WW 56, YW 93, Milk 20.</p>	<p>Lot 71 WHEAT MR SUPREME DRAFT 1-229 M988488 WHITE POLLED Calved 09/22/2021 Consigned By: Wheatcraft Farms Tattoo 1-229 LE Brookfield, Mo.</p> <p>CML DRAFT PICK 436B EM866472 WELLS MR SUPREME DRAFT 748 M897487 GCR MISS T48 F1143689</p> <p>MEAD LEDGER P300 M862271 WHEATCRAFT MISS LEDGER 7-261 F1260283 SILVER NUGGET 2-236 F1170130</p> <p>EPD's: CE 10.9, BW 0.0, WW 53, YW 92, Milk 20.</p>
<p>Lot 68 WHEAT MR. SUPREME DRAFT 1-221 M988485 WHITE POLLED Calved 09/12/2021 Consigned By: Wheatcraft Farms Tattoo 1-221 LE Brookfield, Mo.</p> <p>CML DRAFT PICK 436B EM866472 WELLS MR SUPREME DRAFT 748 M897487 GCR MISS T48 F1143689</p> <p>MEAD LEDGER P281 M862255 WHEATCRAFT MISS LEDGER 7-217 F1260206 SILVER NUGGET 4-119 F1200787</p> <p>EPD's: CE 9.7, BW 0.2, WW 53, YW 91, Milk 22.</p>	<p>Lot 72 WHEAT MR RUSHMORE 1-230 M988489 WHITE POLLED Calved 09/22/2021 Consigned By: Wheatcraft Farms Tattoo 1-230 LE Brookfield, Mo.</p> <p>MEAD RUSHMORE Q798 M891379 MEAD Q798 RUSHMORE S1696 M922516 MEAD P769 OF I017 P F1219422</p> <p>M6 RANCH HAND 510 M855671 WHEATCRAFT RANCH HAND 7-230 F1260211 SILVER NUGGET 2-17 F1165531</p> <p>EPD's: CE 14.4, BW -1.2, WW 53, YW 102, Milk 27.</p>
<p>Lot 69 WHEAT MR. SUPREME DRAFT 1-225 M988486 WHITE POLLED Calved 09/15/2021 Consigned By: Wheatcraft Farms Tattoo 1-225 LE Brookfield, Mo.</p> <p>CML DRAFT PICK 436B EM866472 WELLS MR SUPREME DRAFT 748 M897487 GCR MISS T48 F1143689</p> <p>M6 RANCH HAND 510 M855671 WHEATCRAFT RANCH HAND 7-235 F1260212 SILVER NUGGET 6-300 F1063762</p> <p>EPD's: CE 9.6, BW 0.1, WW 46, YW 77, Milk 21.</p>	<p>Lot 73 WHEAT MR. SUPREME DRAFT 1-231 M988490 WHITE POLLED Calved 09/30/2021 Consigned By: Wheatcraft Farms Tattoo 1-231 LE Brookfield, Mo.</p> <p>CML DRAFT PICK 436B EM866472 WELLS MR SUPREME DRAFT 748 M897487 GCR MISS T48 F1143689</p> <p>FINK 3784 OF 9725 GS EM845815 WHEAT MISS FINK 5-204 F1222457 SILVER NUGGET 8-37 F1101647</p> <p>EPD's: CE 10.3, BW 0.2, WW 51, YW 86, Milk 18.</p>

OUR MISSION

EQUIPPING MEN TO PROVIDE FOR THEIR FAMILIES WITH
DIGNITY AND HONOR FOR THE GLORY OF GOD.



APPLY AT
maxxdtrailers.com



MAXX-D
TRAILERS

WE BUILD TRAILERS
FOR THE WORKING MAN.

<p>Lot 74 WHEAT MR SUPREME DRAFT 1-234 M988492 WHITE POLLED Calved 09/30/2021 Consigned By: Kason Foster Tattoo 1-234 LE Brookfield, Mo.</p> <p>CML DRAFT PICK 436B EM866472 WELLS MR SUPREME DRAFT 748 M897487 GCR MISS T48 F1143689</p> <p>FINK 3784 OF 9725 GS EM845815 WHEAT MISS FINK 5-202 F1222456 SILVER NUGGET 6-242 F1063744</p> <p>EPD's: CE 10.1, BW -0.3, WW 42, YW 74, Milk 19.</p>	<p>Lot 76 WHEAT MR. RUSHMORE 1-240 M988494 WHITE POLLED Calved 10/04/2021 Consigned By: Kason Foster Tattoo 1-240 LE Brookfield, Mo.</p> <p>MEAD RUSHMORE Q798 M891379 MEAD Q798 RUSHMORE S1696 M922516 MEAD P769 OF I017 P F1219422</p> <p>M6 COOL REP 422 M855903 WHEATCRAFT COOL REP 7-280 F1260286 SILVER NUGGET 0-200 F1137481</p> <p>EPD's: CE 14.3, BW -1.7, WW 53, YW 101, Milk 26.</p>
<p>Lot 75 WHEAT MR SUPREME DRAFT 1-237 M988493 WHITE POLLED Calved 10/04/2021 Consigned By: Kason Foster Tattoo 1-237 LE Brookfield, Mo.</p> <p>CML DRAFT PICK 436B EM866472 WELLS MR SUPREME DRAFT 748 M897487 GCR MISS T48 F1143689</p> <p>FINK 3784 OF 9725 GS EM845815 WHEAT MISS FINK 5-238 F1222507 SILVER NUGGET 1-250 F1153948</p> <p>EPD's: CE 10.6, BW -0.3, WW 48, YW 84, Milk 18.</p>	<p>Lot 77 WHEAT MR. FLASH 1-214 M988495 WHITE POLLED Calved 10/06/2021 Consigned By: Kason Foster Tattoo 1-241 LE Brookfield, Mo.</p> <p>ONE PENNY BLANCO FLASH 6424 M731925 JCR FLASH 721 P M895289 JCR BLUEGRASS 283 P F1153738</p> <p>EC-JAB BUD 108 POLLED EM809502 SILVER NUGGET 4-119 F1200787 SILVER NUGGET 1-246 F1153946</p> <p>EPD's: CE 8.5, BW 0.4, WW 54, YW 107, Milk 21.</p>

COMPLIMENTS of
BRANDON BELL,
Lamar County Judge
Supporting
The 58th Annual
Red River Valley



ALL BREED BULL SALE

Lot 78	WHEAT MR. FLASH 1-214	M988496	Lot 79	WHEAT MR. RUSHMORE 1-246	M988497
	WHITE	POLLED		WHITE	POLLED
Calved 10/06/2021	Consigned By: Kason Foster		Calved 10/10/2021	Consigned By: Kason Foster	
Tattoo 1-242 LE	Brookfield, Mo.		Tattoo 1-246 LE	Brookfield, Mo.	
	ONE PENNY BLANCO FLASH 6424	M731925		MEAD RUSHMORE Q798	M891379
JCR FLASH 721 P		M895289	MEAD Q798 RUSHMORE 51696		M922516
JCR BLUEGRASS 283 P		F1153738	MEAD P769 OF I017 P		F1219422
	EC-JAB BUD 108 POLLED	EM809502	FINK 3784 OF 9725 GS		EM845815
SILVER NUGGET 4-206		F1204700	WHEATACRAFT G STANDARD 7-297		F1260289
SILVER NUGGET 1-265		F1153936	SILVER NUGGET 8-142		F1101627
EPD's: CE 7.7, BW 0.4, WW 53, YW 106, Milk 19.			EPD's: CE 14.1, BW -1.5, WW 59, YW 108, Milk 26.		



Liberty national bank

(903) 785-5555 www.lnbparis.com



**Main Office:
305 Lamar Avenue**



**Branch:
140 N. Collegiate**



**Liberty National Bank proudly supports the Annual
Red River Valley All Breed Bull Sale**



HEREFORD

Hereferd Breed EPD Averages - September 2023

	CED	BW	WW	YW	SC	DMI	SCF	MM
Active Sire	3.0	2.7	55	88	1.0	0.2	15.9	26

M&G	CEM	MCW	UDDR	TEAT	CW	Marb	REA	Fat
54	2.0	88	1.2	1.2	69	0.13	0.42	.019

Lot 82 STEWART CATAPULT 583 K6 P44383963

POLLED

Calved 01/27/2022 Consigned by Stewart Polled Herefords
Tattoo K6 Campbell, Tx

CRR719CATAPULT109 SODDLF,HYF,IEF,MDF P43186342
STEWART CATAPULTW76E70ET DLF,HYF,IEF,MSUDF P43878618
-S LADY ADVANCE DOM 4261 W76 DLF,HYF,IEF,MSUDF 43025014

C GOHR THRILL RIDE 4105 DLF,HYF,IEF,MSUDF P43499321
BHR MISS THRILLER 583 P43716002
HERITAGE SNOOKIE 11253 ET P43233360

EPD's: CE -1.4, BW 4.5, WW 54, YW 85, DMI 0.0.

Lot 81 STEWART CATAPULT 4064 K1 44383960

HORNED

Calved 01/05/2022 Consigned by Stewart Polled Herefords
Tattoo K1 Campbell, Tx

CRR719CATAPULT109 SODDLF,HYF,IEF,MDF P43186342
STEWART CATAPULTW76E70ET DLF,HYF,IEF,MSUDF P43878618
-S LADY ADVANCE DOM 4261 W76 DLF,HYF,IEF,MSUDF 43025014

GBL1DOMINO 177R SOD DLF,HYF,IEF 43193863
HMS 2010 ZALEAH 4064 DLF,HYF,IEF,MSUDF 43522965
HW4 ZALEAH 2010 ET DL F,HYF,IEF 43295486

EPD's: CE 0.1, BW 3.0, WW 60, YW 91,DI 0.3.

Lot 83 RSS POWER SURGE 2207 P44365007

{DLP,HYP}

POLLED

Calved 02/22/2022 Consigned by: R. Schlegel & Sons
Tattoo 2207 Olney, Tx.

BOYD 31Z BLUEPRINT 6153 P043764491
{DLY,HYF,IEF,MSUDF,MDF}
BOYD POWER SURGE 9024 {DLF,HYF,IEF,MSUDF, MDF} P44004782
TH 329 358C LANA 76E {DLF,HYF,IEF,MSUDF} P43818744

RSS CHANNING GOLD 0901 ET {DLF,HYF,IEF} 42980212
RSS FRAU 0901 1507 {DLP,HYP} 43598525
RSS KITTY 0946 {DOD,DLP,HYP} 43051003

A young Polled Power Surge son you don't want to miss. Sound and muscular.

EPD's: BW +2.9 WW +55, YW +88, Milk +52.

TACO DELITE

1580 Clarksville St.

903-785-7173



<p>Lot 84 RSS 1321 ROTE APFUL 2017 44199408 {DLF,HYF,IEF,MSUDF,MDF} HORNED Calved 08/29/2020 Consigned by: R. Schlegel & Sons Tattoo 2017 Olney, Tx.</p> <p>LJS MARK DOMINO 0945 {CHB,DLF,HYF,IEF,MSUDF} 43000470 LJS MARK DOMINO 1321 {CHB,DLF,HYF,IEF,MSUDF,MDF} 43394744 LJS MS MARK DOMINO 1125 {DLF,HYF,IEF} 43202142</p> <p>CJH HARLAND 408 42536808 {SOD,DLF,HYF,IEF,MSUDF,MDF}</p> <p>RSSLGH ROTE APFUL SCHEIB 150213 43598562 BSS FRAU KATZE 1304 P43391113</p> <p>A dark Red bull with excellent growth, muscle and maternal EPDS. A proven calving ease bull.</p> <p>EPD's: CE +7.0, BW +3.7, WW +57, YW +102, Milk +32.</p>	<p>Lot 88 BK VC PROFIT 16DK (VC16DK) 44502885 Calved 02/21/2022 Consigned by: Buck Cattle Co. Tattoo VC16DK Madill, Ok.</p> <p>Sire: H THE PROFIT 8426 ET (8426) P43916400 Dam: HAPP DREW 16D ET (16D) P43728536</p> <p>EPDS: None Available.</p>
<p>Lot 85 BK VC DOMINATE 753K (VC753K) 44502887 _F,HYF,IEF,MSUDF,MDF} Calved 02/03/2022 Consigned by: Buck Cattle Co. Tattoo VC753K Madill, Ok.</p> <p>Sire: SR DOMINATE 308F ET (308) 43954712 Dam: VC EASY PICK 753E (753E) P43841439</p>	<p>Lot 89 BK NO FAIL 0131K (BUCK0131K) P44406820 Calved 03/10/2022 Consigned by: Buck Cattle Co. Tattoo BUCK0131K Madill, Ok.</p> <p>Sire: ECR 11E NO FAIL 0127 (0127) P44196236 Dam: BK HANGING THE POINTS 0131H ET (BUCK0131H) P44204481</p> <p>EPDS: CE -1.1 BW 5.0, WW 72, YW 121.</p>
<p>Lot 86 CMCC 991G STANDOUT K211 (CMCCK211) P44432519 HORNED Calved 03/02/2022 Consigned by: Buck Cattle Co. Tattoo CMCC211 Madill, Ok.</p> <p>Sire: JDH AH STANDOUT 16G ET (16G) P44014200 Dam: CMCC 6067D MISS 2296 991G ET (CMCCC991G) P44129691</p> <p>EPDS; CE 2.0, BW 3.5, WW 64, YW 98.</p>	<p>Lot 90 BK VC ADVENTURE 913AK (VC9134K) P44502889 Calved 02/14/2022 Consigned by: Buck Cattle Co. Tattoo 9134K Madill, Ok.</p> <p>Sire: ECR 3116 ADVENTURE 7647 ET (7647) P43855282 Dam: VC GLADIOLUS 9134G (VC9134G) P44115187</p> <p>EPDS: None Available.</p>
<p>Lot 87 OR L574 PIONEER B1111 (1111) 44406885 Calved 06/17/2021 Consigned by: Buck Cattle Co. Tattoo 1111 Madill, Ok.</p> <p>Sire: OR N162 HUSKER L574 (574) 43745946 Dam: OR N151 MISS HUSKER S628 (628) 43860132</p> <p>EPDS; CE 1.3, BW 3.7, WW 53, YW 99.</p>	<p>Lot 91 BK VC PROFIT 9119K (VC9119K) P44502886 Calved 02/18/2022 Consigned by: Buck Cattle Co. Tattoo 9119K Madill, Ok.</p> <p>Sire: H THE PROFIT 8426 ET (8426) P439164002 Dam: VC GAGA LADY 9119G ET (VC919G) P44115402</p> <p>EPDS: None Available.</p>
	<p>Lot 92 CMCC 781E DOMINATE K216 ET (CMCCK216) P44439764 Calved 02/20/2022 Consigned by: Buck Cattle Co. Tattoo CMCC216 Madill, Ok.</p> <p>Sire: SR DOMINATE 308F ET (308) 43954712 Dam: CMCC 337U MISS 88X 781 E ET (CMCC781E) P44127762</p> <p>EPDS; CE 1.9, BW 3.4, WW 56, YW 90.</p>



TEXAS FARM CREDIT

Let Texas Farm Credit help you finance your farm or ranch operations with our offering of ag loans, operating lines of credit, agribusiness capital, and equipment loans.

Contact our offices

Bonham: 903-583-3217 Sulphur Springs: 903-885-7608



Contact our Agents

JP Ayad: 903-990-6346 Austin Miles: 903-253-3504

Texas Farm Credit has served farmers and ranchers for generations, so we understand production agriculture and rural living. We offer insurance programs for both livelihood and life while valuing your concerns as much as you do.



TEXAS FARM CREDIT

INSURANCE DIVISION

<p>Lot 93 BK DOMINATE K7027 ET (BUCKK7027) 44406838</p> <p>Calved 02/02/2022 Consigned by: Buck Cattle Co. Tattoo BUCKK7027 Madill, Ok.</p> <p>Sire: SR DOMINATE 308F ET (308) 43954712</p> <p>Dam: SR 5051 824 CAMBRIA 7027 (7027) P43853399</p> <p>EPD's: CE -0.4, BW 4.5, WW 65, YW 110.</p>	<p>Lot 97 4S HIGHLAND 0 120K P44321963 POLLED</p> <p>Calved 01/20/2022 Consigned by: 4S Farms, LLC Tattoo 0120K Denison, Tx.</p> <p>TH 90U 17Y LAMBEAU 148B P43464730 DLF,HYF,IEF</p> <p>S16 782B HIGHLAND 84E P43779333 DLF,HYF, IEF,MSUDF,MDF</p> <p>RANGELINE 511X MOLASSES782BET P43544274 DLF,HYF,IEF,MSUDF</p> <p>/S JBB/AL BOOM TOWN 4460B P43567160 CHB DLF,HYF,IEF,MSUDF,MDF</p> <p>/S LADY BOOM TOWN 8193F ET P43971712 DLF,HYF,IEF,MSUDF</p> <p>/S LADY ON TARGET 5002C ET P43616715 DLF,HYF,IEF,MSUDF</p> <p>EPD's: CE 7.6, BW 1.2, WW 58 YW 94.</p>
<p>Lot 94 BK BELLE AIR J71 (BUCKJ71) P44302690</p> <p>Calved 01/12/2021 Consigned by: Buck Cattle Co. Tattoo BUCKJ71 Madill, Ok.</p> <p>Sire: UPS SENSATION 2296 ET (2296) 43311175</p> <p>Dam: BR BRIANNE 3035 (3035) P43412001</p> <p>EPD's: CE12.0, BW 0.0, WW 58, YW 91.</p>	<p>Lot 98 4S INNISFAIL TB 110J P44239579 POLLED</p> <p>Calved 01/10/2021 Consigned by: 4S Farms, LLC Tattoo TB110J Denison, Tx.</p> <p>EBEEF TFL U208 TESTED X651 ET P43091736 SOD,CHB DLF,HYF,IEF,MSUDF</p> <p>INNISFAIL WHR X651/723 4013 ET P43541960 CHB DLF,HYF, IEF,MSUDF,MDF</p> <p>INNISFAIL P230 T723 P42843247 DLF,HYF,IEF,MSUDF</p> <p>HH ADVANCE 286M 1ET 42302052 SOD DLF,IEF</p> <p>/S LADY ADVANCE 8190F ET P43953620 DLF,HYF,IEF,MSUDF</p> <p>JET MS X010 P43094958 DLF,HYF,IEF</p> <p>EPD's: CE 2.0, BW 3.5, WW 71, YW 111.</p>
<p>Lot 95 RSS KLIEN STADT JUNGE 2101 P44264138 POLLED</p> <p>Calved 01/27/2021 Consigned by: 4F Cattle Co. Tattoo 2101 Whitesboro, Tx.</p> <p>NJW 73S W18 HOMETOWN 10Y ET P43214853 SOD, CHB DLF, HYF, IEF, MSUDF</p> <p>KT SMALL TOWN KID 5051 P43621413 CHB DLF,HYF, IEF,MSUDF,MDC</p> <p>KT MS 0124 TIMES A WASTIN 2086 43290330 DOD DLF,HYF,IEF</p> <p>RSS 0706 HERR 1602 43705139 DLF,HYF,IEF,MSUDF</p> <p>RSS 1602 FRAU 1809 P43899820 DLF,HYF,IEF</p> <p>RSS LA GATA DE ORO 1117 P43186399</p> <p>EPD's: CE 10.8, BW 2.2, WW 60, YW 96.</p>	<p>Lot 99 4S GRETZKY 1106J P44298882 POLLED</p> <p>Calved 11/06/2021 Consigned by: 4S Farms, LLC Tattoo 1106J Denison, Tx.</p> <p>BR BELLE AIR 6011 43724674 CHB DLF,HYF,IEF,MSUDF</p> <p>WF GRETZKY 201 ET (G201) P44046609 DLF,HYF, IEF,MSUDF</p> <p>WF MISS SOLUTION C900 ET P43684442 DLF,HYF,IEF,MSUDF</p> <p>MCS 9A TYMELESS 1509 P43687920 DLF,HYF,IEF,MSUDF</p> <p>SFCC GRACIE 1737 P43846766</p> <p>SFCC 11X GRACES HOPE 125A P43687955 DLF,HYF,IEF,MSUDF</p> <p>EPD's: CE 3.4, BW 1.9, WW 56, YW 87.</p>
<p>Lot 96 4S MANDATE 0305K P44332177 POLLED</p> <p>Calved 03/05/2022 Consigned by: 4S Farms, LLC Tattoo 0305K Denison, Tx.</p> <p>R LEADER 6964 P43500058 SOD DLF,HYF,IEF,MSUDF</p> <p>/S MANDATE 66589 ET P43834732 CHB DLF,HYF, IEF,MSUDF,MDF</p> <p>/ S LADY DOMINO 0158X 43090011 DLF,HYF,IEF</p> <p>EFBEEF TFL U208 TESTED X651 ET P43091736 SOD,CHB DLF,HYF,IEF,MSUDF</p> <p>/ S LADY TESTED 994G ET P44072403 DLF,HYF,IEF,MSUDF</p> <p>S LADY DOMINO 0229X 43089976 DLF,HYF,IEF</p> <p>EPD's: CE 7.7, BW 0.5, WW 66 YW 99.</p>	

<p>Lot 100 4S GRETZKY 1013J 44298873 HORNED</p> <p>Calved 10/13/2021 Consigned by: 4S Farms, LLC Tattoo 1013J Denison, Tx.</p> <p>BR BELLE AIR 6011 43724674 CHB DLF,HYF,IEF,MSUDF</p> <p>WF GRETZKY G201 ET (G201) P44046609 DLF,HYF, IEF,MSUDF</p> <p>WF MISS SOLUTION C900 ET P43684442 DLF,HYF,IEF,MSUDF</p> <p>MCS 9A TYMELESS 1509 P43687920 DLF,HYF,IEF,MSUDF</p> <p>SFCC MAGIC MAID 1735 P43846763</p> <p>PRO TRM PURPLE MAGIC 2166 ET 43367822 DLF,HYF,IEF,MSUDF</p> <p>EPD's: CE 2.3, BW 2.0, WW 59 YW 93.</p>	<p>Lot 103 RKF BENTON BELLE 005X184 P44310478 POLLED</p> <p>Calved 10/02/2021 Consigned by: RK Cattle Co. Tattoo 1001J Dodd City, Tx.</p> <p>JDH 11B STUD 3134 63E P43782967 DLF,HYF,IEF,MSUDF</p> <p>JDH AH BENTON 8G ET P44014184 DLF,HYF, IEF,MSUDF,MDF</p> <p>JDH AH MS 34X VICTOR 33Z45C ET P43615978 DLF,HYF,IEF,MSUDF</p> <p>RED VORTEX 435X445 SRR712 P43785127 DLF,HYF,IEF</p> <p>SOUTHERN BELLE VORTEX 078X69 P44095090 RMB B262 SOUTHERN BELLE 033E P43774599 DLF,HYF,IEF,MSUDF</p> <p>WOW is the best word to describe this bull! Not only does he have the looks that will be passed on to his calves but look at the growth and power that this bull provides!! With a 66 WW EPD ranking in the top 10% of the breed, and YW EPD ranking in the top 5% of the breed, this bull not only will give your calves the eye appeal that buyers are wanting, but he will put the lbs on calves at weaning as well! EPD's: CE 1.4, BW 4.1, WW 79, YW 126.</p>
<p>Lot 101 RED STELLAR 9341X407 SRR141 P44280752 POLLED</p> <p>Calved 08/29/2021 Consigned by: RK Cattle Co. Tattoo 141 Dodd City, Tx.</p> <p>KCF BENNETT RELEVANT D67 ET P43694844 CHB DLF,HYF,IEF,MSUDF</p> <p>BR STELLER D67 6241 9341 P44022243 DLF,HYF, IEF,MSUDF,MDF</p> <p>BR HOMETOWN 10Y 2108 6221 P43744657 DLF,HYF,IEF,MSUDF</p> <p>RED DIAMOND SRR 117 P43198445 DLF,HYF,IEF</p> <p>PERFECTA 117X205 SRR 407 P43460338 PERFECTA SRR 205 P43259289</p> <p>Check out the consistency of this bull! Ranking better than half the breed on Calving Ease, BW, WW and YW, this bull will give you the consistency in your calf crop. Steers with great weaning weight and heifers that will make great replacements should come from this bull. EPD's: CE 2.4, BW 2.4, WW 57, YW 93.</p>	<p>Lot 104 RKF BENTON ADVANCE 077X184 P44309052 HORNED</p> <p>Calved 10/06/2021 Consigned by: RK Cattle Co. Tattoo 1003J Dodd City, Tx.</p> <p>JDH 11B STUD 3134 63E P43782967 DLF,HYF,IEF,MSUDF</p> <p>JDH AH BENTON 8G ET P44014184 DLF,HYF, IEF,MSUDF,MDF</p> <p>JDH AH MS 34X VICTOR 33Z45C ET P43615978 DLF,HYF,IEF,MSUDF</p> <p>CX 2185 ADVANCE 1449 43545283 DLF,HYF,IEF,MSUDF</p> <p>DHR 1449 ADVANCE DOMINO 848 43891736 F 480 DOMINETTE 169 43173760</p>
<p>Lot 102 RED STELLAR 9341X623 SRR134 P44275531 HORNED</p> <p>Calved 08/07/2021 Consigned by: RK Cattle Co. Tattoo 134 Dodd City, Tx.</p> <p>KCF BENNETT RELEVANT D67 ET P43694844 CHB DLF,HYF,IEF,MSUDF</p> <p>BR STELLER D67 6241 9341 P44022243 DLF,HYF, IEF,MSUDF,MDF</p> <p>BR HOMETOWN 10Y 2108 6221 P43744657 DLF,HYF,IEF,MSUDF</p> <p>RED FOREMOST SRR 404 P43460335 DLF,HYF,IEF</p> <p>RED BLISS 404X346 SRR 623 P43682774 PERFECTA 117X119 SRR 346 P43431620</p> <p>Check out the Calving Ease on this bull!! If you have a group of black heifers to breed, this bull will work great to give you the black baldy calves that will be desired by many. With a near double digit calving ease ranking in the top 7% of the breed, and a negative BW EPD ranking in the top 4% of the breed, you can feel great about using this bull on heifers. EPD's: CE 8.9, BW -0.5, WW 51, YW 82.</p>	<p>If you're looking for a bull that will put BIG TIME GROWTH in your calves, look no WW EPD ranking in the top 15% of the breed, and a YW EPD in the top 4% of the breed, you can feel sure that this bull's calves will mash the scales down! EPD's: CE 1.4, BW 4.1, WW 79, YW 126.</p> <p>Lot 105 FWS 5002 DOMINO 2107 44243376 HORNED</p> <p>Calved 02/28/2021 Consigned by: Jamison Ranch Tattoo 2107 Beggs, Ok.</p> <p>CL 1 DOMINO 9125W 1ET 42994844 SOD DLF,HYF,IEF</p> <p>JRL1 DOMINO 5002C 43658840 DLF,HYF,IEF,MSUDF</p> <p>JAL1 DOMINETTE 650S 42717361</p> <p>CL 1 DOMINO 638S 42673573 SOD DLF, IEF</p> <p>JR L1 DOMINETTE 2142Z 43412371 FWS 426 CELESTE 1072 43161481</p> <p>EPD's: CE 1.9, BW 3.9, WW 48, YW 80.</p>

Lot 106 JR L1 DOMINO 1024J 44334863
 HORNED
 Calved 02/20/2021 Consigned by: Jamison Ranch
 Tattoo 1024 Beggs, Ok.
 DH ADVANCE 031 43220398
 JA L1 DOMINO 7838E 43798269
 DLF, HYF, IEF, MSUDF
 JA L1 DOMINETTE 2137Z 43299806
 DOD
 DH DOMINO 236Z 43352351
 DLF, HYF, IEF, MSUDF
 JR L1 DOMINEETTE 83F 44068642
 JM L1 DOMINETTE 5806C 43690018

Lot 108 RSS POWER SURGE 2208 P44365004
 POLLED
 Calved 02/25/2022 Consigned by: R. Schlegel & Sons
 Tattoo 2208 Olney, Tx.
 BOYD 31Z BLUEPRINT 6153 P043764491
 {DLY, HYF, IEF, MSUDF, MDF}
 BOYD POWER SURGE 9024 {DLF, HYF, IEF, MSUDF, MDF} P44004782
 TH 329 358C LANA 76E {DLF, HYF, IEF, MSUDF} P43818744
 RSS 0706 HERR 1602 {DLF, HYF, IEF, MSUDF} 43705139
 RSS 1602 FRAU 1809 {DLF, HYF, IEF} P43899820
 RSS LA GATA DE ORO 1117 {DLP, HYP} P43186399

EPDS: CE 0.5., BW 2.9, WW 57, YW 87.

EPD's: BW +4.6, WW +65, YW +99, Milk +33.

Lot 107 JR L1 DOMINO 1914J 44356875
 HORNED
 Calved 03/01/2021 Consigned by: Jamison Ranch
 Tattoo 1914 Beggs, Ok.
 CL 1 DOMINO 386A 1ET DLF, HYF, IEF 43379798
 JA L1 DOMINO 6906D 43678919
 DLF, HYF, IEF, MSUDF
 JA L1 DOMINETTE 0722X 43130200
 DOD
 CL 1 DOMINO 638S 42673573
 SOD DLF, IEF
 HWM JR L1 DOMINETTE 31066A 43413013
 JA L1 DOMINETTE 9519W 433032853
 DOD

EPDS: CE 3.1., BW 2.7, WW 55, YW 83.



MAINE ANJOU

Maine-Anjou Breed EPD Averages

	CED	BW	WW	YW	MK
Active Sire	6	2.1	44	56	19

TM	CEM	CW	Marb	RE	Fat
41	1	9	0.09	.0.29	-0.04

Lot 112 **BK FLEX 9107K** **545209**
POLLED - BLACK
 Calved 3/03/2022 C Consigned by: Jeril Buck
 Tattoo 9170K Madill, Ok.

[KBSC22C] KBSC SIMPLIFY 22C -PHAF THF 457093
[BOE224H] BOE FLEX -PHAF THF 515680
 [BBR 1291Z] BBR MS 1291Z PHAF THF 437695

[131UBPF] BPF MERCEDES BENZ 131U
 AMF CAF NHF PHAF THF 386737
[BUCK 9170G] BK GLOWING 9170G - PHF THF 505421
 [WSCC 84E] WSCC CHLOE 84E PHAF THF 480939

Lot 110 **BK EPIC 9176K** **545211**
POLLED - BLACK

Calved 3/27/2022 C Consigned by: Jeril Buck
 Tattoo 9176K Madill, Ok.

[BOE40B] BOE GARTH - PHAF THF 447000
[BOE600D] BOE EPIC - CAF NHF PHAF THF 474260
 [BOE502R] MISS BOE 502R 357725

[608E] GCC GOLD STANDARD 608E -PHAF THF AN19050136
[BUCK 9176G] BK GOLD MATTERS 9172G -PHF THF 510315
 [BUCK 7145E] BK EASY MATTERS 7145E ET
 PHAF THF 509371

Lot 113 **BK INSIGHT 0176K** **545210**
POLLED - BLACK

Calved 2/23/2022 C Consigned by: Jeril Buck
 Tattoo 0176K Madill, Ok.

PVF INSIGHT 0129 AN16805884
 AMF CAF DDF NHF OSF PHAF THF
[0031] EXAR INSIGHT 0031 -PHAF THF AN19799960
 [4084] C&C WINNIE 4084 - PHAF THF AN18091037

[708] WB PEDLETON 708 PVF SWSN - AN18865549
 PHAF THF
[BUCK 0176H] BK HOT TO TROT 0176H ET 518146
 PHAF THF
 [BUCK872U] BK UTOO 872 - PHAF THF 420234

Lot 111 **CMCC EPIC K205 ET** **545212**
POLLED - BLACK

Calved 2/01/2022 C Consigned by: Jeril Buck
 Tattoo †K205 Madill, Ok.

[BOE408] BOE GARTH - PHAF THF 447000
[BOE600D] BOE EPIC - CAF NHF PHAF THF 474260
 [BOE502R] MISS BOE 502R 357725

[BUCKX59] BK XIKES X59 PHAF THF 416311
[MTF501C] MTF COLD CHILLS 501 -PHAF THF 460485
 [BUCK227Z] BK JFR ZANELLA 227 -PHAF THF
 PHAF THF 428504

SANTA GERTRUDIS

Santa Gertrudis Breed EPD Averages- October 2023

	BW	WW	YW	MILK	TM	SC
Active Sire	0.1	10	13	-0	8	0.40

HP	BB	CW	Marb	REA	Fat
0.87	0.81	-1	0.0123	0.0304	0.000

Lot 115 GRANDVIEW H103 20207309

HORNED

Calved 10/20/2020

Consigned by: Nicholas O'Neal

Tattoo H103

I Como, Texas

1 KING RANCH INC
KR1195/15

20157596

1 KING RANCH INC
KR651/18 (CHOSEN ONE)

20183702

20167 DIAMOND S RANCH
DSR CHERRY 923 1B

1280026

13236 GRANDVIEW FARMS
GRANDVIEW 209

20115991

13236 GRANDVIEW FARMS
MISS GRANDVIEW 738

20168538

17760 EDWARDS DOUBLE E FARMS
1689 9T226

1296180

EPDS: BW -0.1, WW 19, YWT 29, MAT 2.

GRANDVIEW H103

Grandview H103 "Major" 3-year-old Registered Santa Gertrudis Bull. Son of KR651/18 (The Chosen One). "The Chosen One" is a purebred Santa Gertrudis bull from the King Ranch. With leading EPD traits, are in the top 1% in all three indexes and in the top 10% for 10 of 12 breeds. "Majors" DAM Miss Grandview 738 is Deep Red Santa Gertrudis cow that carries the traits you look for in a cow, big hiped, deep bodied with spring of rib. Major is a docile easy keeper. This guy holds his own when it comes to EPD's. Ranking the charts at the Top 10% in carcass weight, top 10% in ribeye area and top 10% in yearling weight and top 25% in fat thickness. Major is wide based, strong top and naturally thick, with the pattern of passing these traits and epd's onto his calf's crops.

Visiting
Angels®



LIVING ASSISTANCE SERVICES

Invitational Replacement Heifer Sale

An added attraction for the 17th year

These Heifer consignments are top, hand selected
Open and Bred. They have been TB tested, Bangs
tested and pregnancy tested, ready for transport
to any state.

SPECIAL COW AND QUALITY YOUNG FEMALE
SALE IMMEDIATELY FOLLOWING THE BULL SALE



Heifers and Cows

Tad Ferguson Whitesboro, Texas	7	Tiger Heifers medium bred to lbw Angus bulls
M Bar Ranch New Boston, Texas	5	Tiger Stripe, 5 to 6 year pairs.
	14	Bred Tiger Striped heifers, bred to lbw Angus bull. Big, nice heifers.
Bruce Conder Powderly, Texas	28	Black & Black Baldie heifers, bred to a registered lbw Angus bull. Bulls put on the 1st of April. Gentle and should average 1,000 lbs.
James Andrews Detroit, Texas	6	Open Tiger Striped heifers, average 600 to 650#, out of Hereford cows and Gray Brahman bull.
Patterson Brangus Ranch Paris, Texas	10	Commercial Heavy Bred Brangus heifers, weigh 1,000#. Bred to lbw Brangus bull.
G Ranch Wilburton, Ok.	40	Fancy, Tiger Striped or Chocolate F1 Bred heifers. 1000 to 1,100#, 4 to 6 months bred to lbw Registered Angus bull.
	5	Heavy bred Brahman cross heifers. Bred to lbw registered Angus bull, 1000 to 1,100 lbs.
D&H Cattle Bullard, Texas	15	F1 Tiger Striped heifers bred to Angus bull, approximately 10 will be pairs by sale day.

**ACCOMODATIONS -
HOTELS/MOTELS**

1st St. Lofts

26 1st ST SE 200
Paris, Texas 75460
(430) 228-3694

American Inn & Suites

2501 N Main St
Paris, TX 75460
(903)-785-9700

Americas Best

Value Inn

3755 NE Loop 286
Paris, TX 75460
(903)-785-5566

Baymont Inn & Suites

3560 Loop 286 NE
Paris, TX 75460
(903)-785-5545

Choctaw Casino & Resort

1516 US Highway 271
Grant, OK 74738
(580) 326-8397

Circle M Farms

2555 CR 33800
Paris, TX 75460
(903)-782-2543

Comfort Inn & Suites

3035 Loop 286 NE
Paris, TX 75460
(903)-785-0089

Days Inn

2650 N. Main St.
Paris, TX 75460
(903)-784-8164

Hampton Inn

3563 Loop 286 NE
Paris, TX 75460
(903)-784-6536

Holiday Inn Express

3025 Loop 286 NE
Paris, TX 75460
(903)-785-0088

Kings Inn

1907 Lamar Ave.
Paris, TX 75460
(903)-739-8499

**LaQuinta Inn & Suites,
Paris**

3205 Loop 286 NE
Paris, TX 75460
(903)-783-9600

Motel 6 of Paris

425 35th St. NE
Paris, TX 75460
(903)-785-3871

**Paris Extended Stay
Suites**

1518 Lamar Ave
Paris, TX 75460
(903)-784-8851

Paris Inn & Suites

3075 NE Loop 286
Paris, TX 75460
(903)-706-5303

Quality Inn

3505 N E Loop 286
Paris, TX 75460
(903)-784-7481

Suite 129

129 Lamar Ave.
Paris, TX 75460
(903)-249-2082

The Emma Grace

131 NW 1st St.
Cooper, Tx 75432
(903)-300-3131

**TownPlace Suites by
Marriott & Fairmont
by Marriott**

3005 North Main St.
Paris, TX 75460
(214) 802-2964

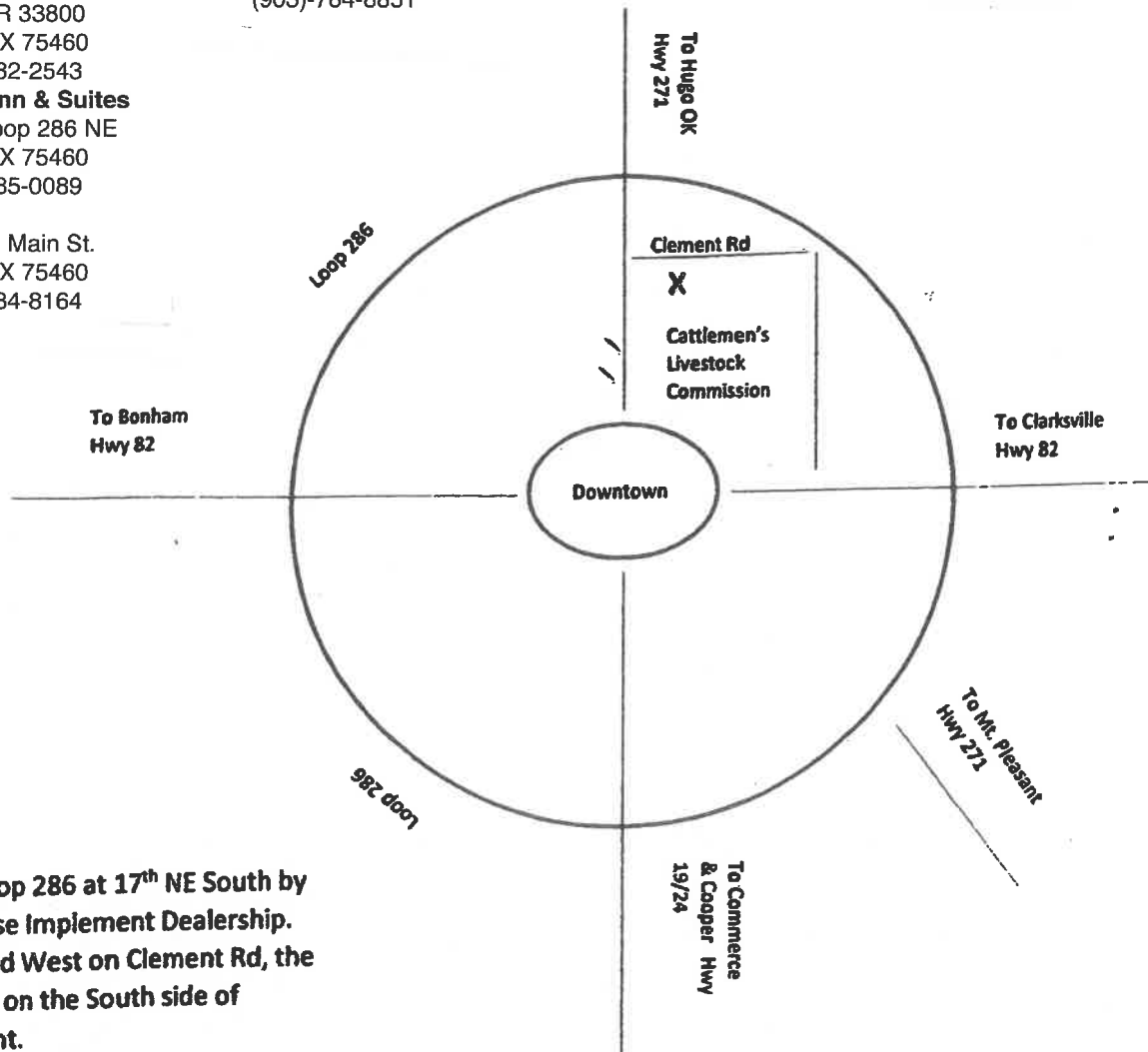

Exit Loop 286 at 17th NE South by
the Case Implement Dealership.
Proceed West on Clement Rd, the
barn is on the South side of
Clement.



Budget Windows



***Some of the benefits
of replacing windows***

Lower Energy Bills

Increase Property Value

Exterior Facelift

Reduce Exterior Noise

Clear - Beautiful Views

Ends Hot and Cold Rooms

Less Dust in Your Home

**Serving North
Texas and
Southern
Oklahoma**

**Grayson County, Fannin
County, Cooke County,
Lamar County, Denton
County, Collin County,
Rockwall County,
Hunt County,
Bryan County, Marshall
County, Atoka County,
Johnston County, Carter
County, Love County**

Since 1959

GOOSTON
& SON

ReadyMix

2550 Lamar Avenue
Paris, Texas 75460

903-785-8484

LANDBROKERcoop

CENTURY 21 FARM & RANCH®

Harvey Properties

c21farm-ranch.com

c21php.com

AMERICAN
FARM + RANCH

YOUR FARM & RANCH REAL ESTATE COMPANY
in Northeast Texas & Southeast Oklahoma for 35 YEARS!



HOMETOWN SERVICE. GLOBAL REACH.

Accredited Land Consultants • Appraisers • Brokers