

PORTAGE COUNTY BUSINESS PARK

Site Development Plan

- Highway Commercial
- Large Business Facilities
- Highway Office
- Business / Professional Offices
- Office / Light Industrial
- Lands' End
- Medium / Large Scale Industrial
- Large Scale Rail Industrial
- Park / Open Space Easements

Highway Commercial, Large Business Facilities, Highway Office, and Business / Professional Office uses allowed in this district.

Utilities

- Bicycle / Pedestrian Path
- Easement Boundary
- Overhead Transmission Lines



Feet

0 200 400 600 800



Planning and Zoning Department
1462 Strongs Avenue
Stevens Point, WI 54481
Production Date: January 7, 2014

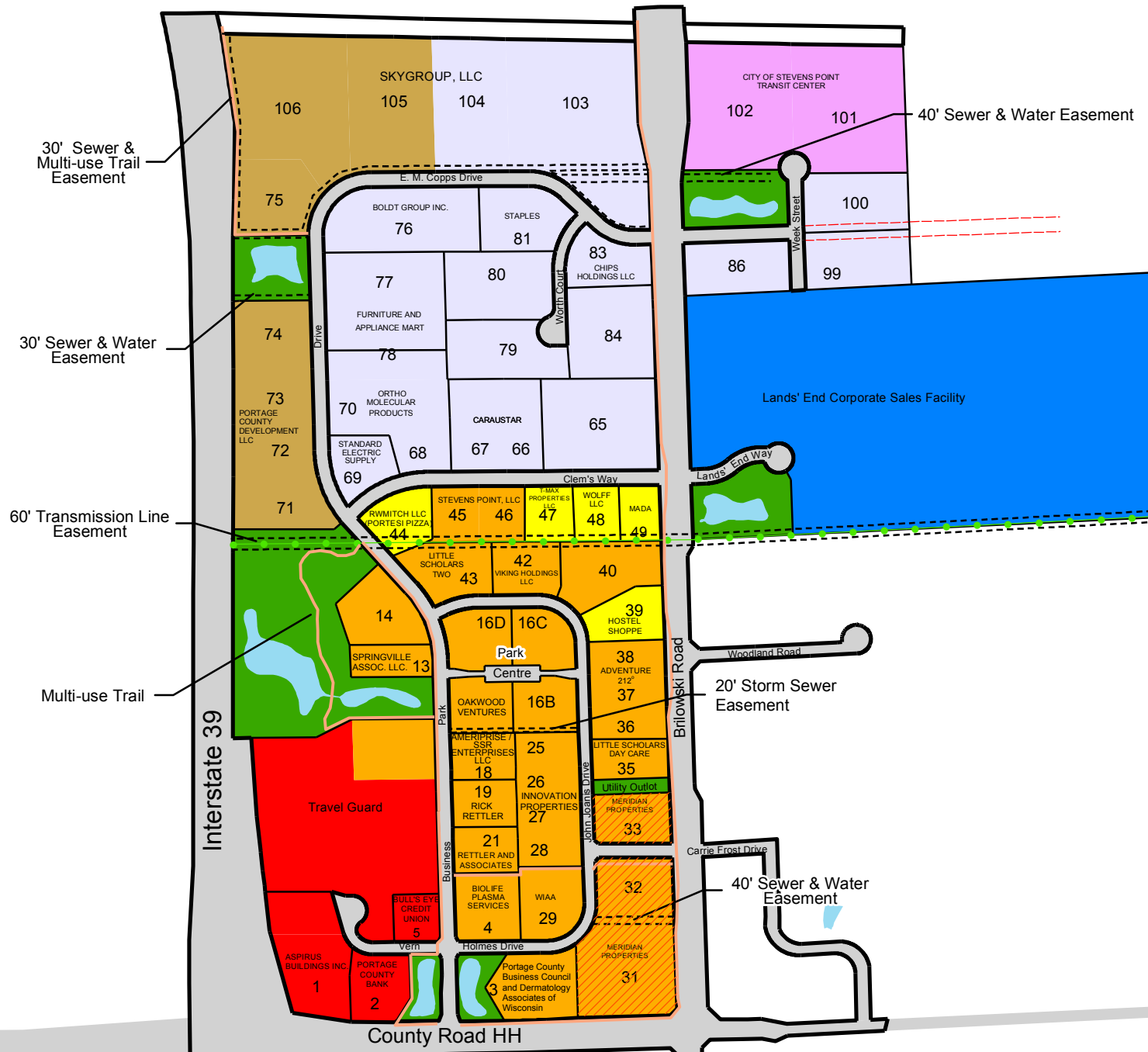

County Road HH