





# Quality of Life Projects

Recreation, Cultural, and Public Safety

# Zoo City Sportsplex



8 full size fields  
2.5 miles trails  
Volleyball Courts  
Pickleball Courts  
Playground  
Picnic Shelters  
Dog Park  
Concessions  
Facility  
Restrooms

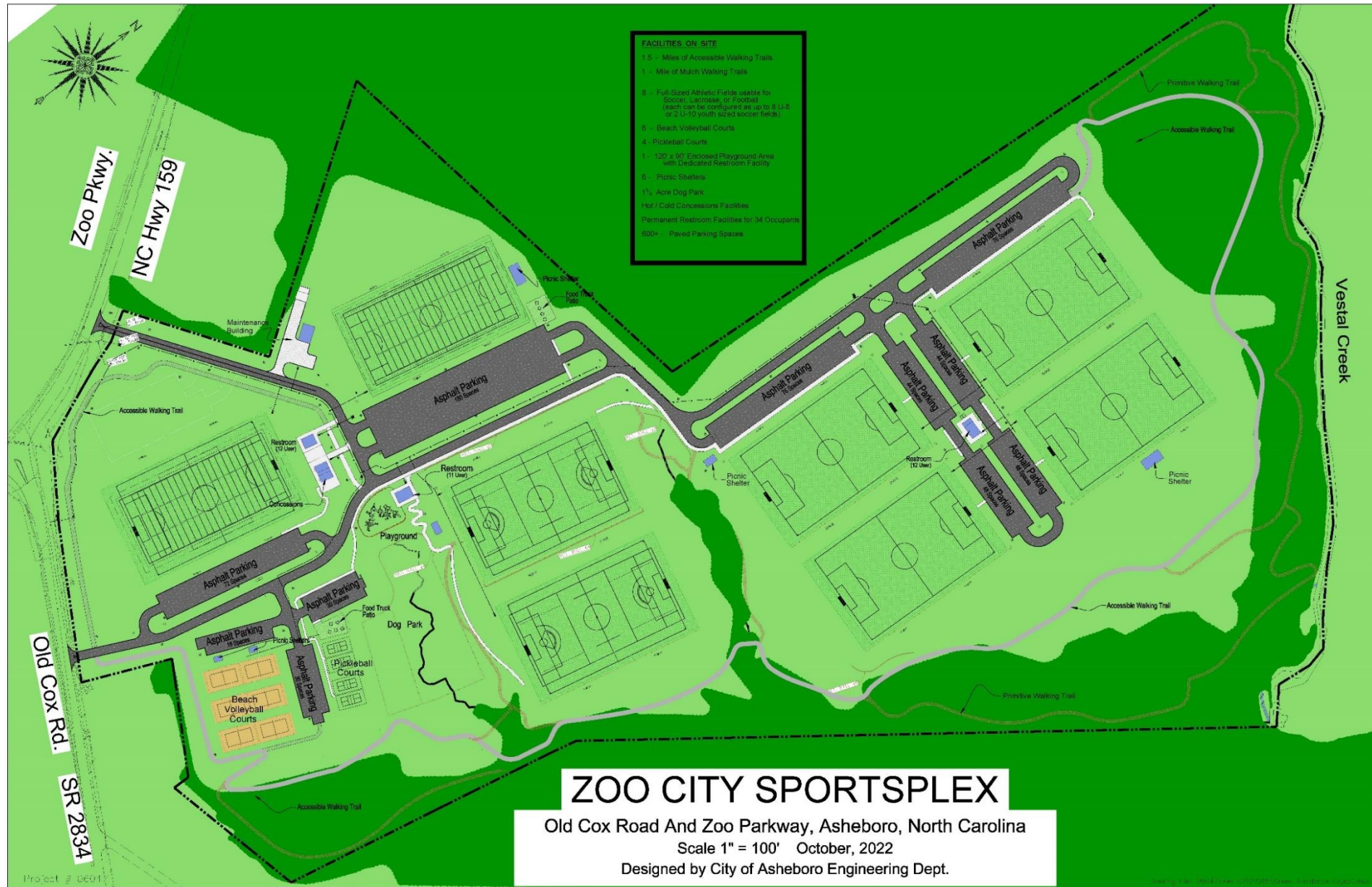

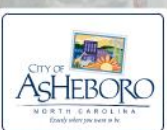

National Register Boundary Map and Photograph Key  
 Asheboro Downtown Historic District  
 Asheboro, Randolph County, NC

Legend

- 000 Address Numbers
- NC Noncontributing Resource
- District Boundary
- Photo Views
- A-K Lat/Long Coordinates
- P Parking
- V Vacant Lot
- Parcel Tie Line

Contributing Status is indicated for primary resources only. See inventory list for status of secondary resources

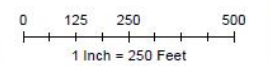

Date of Aerial Photography: Feb/Mar 2018

National Register  
 Listed in 2022  
 (78 recognized  
 structures)

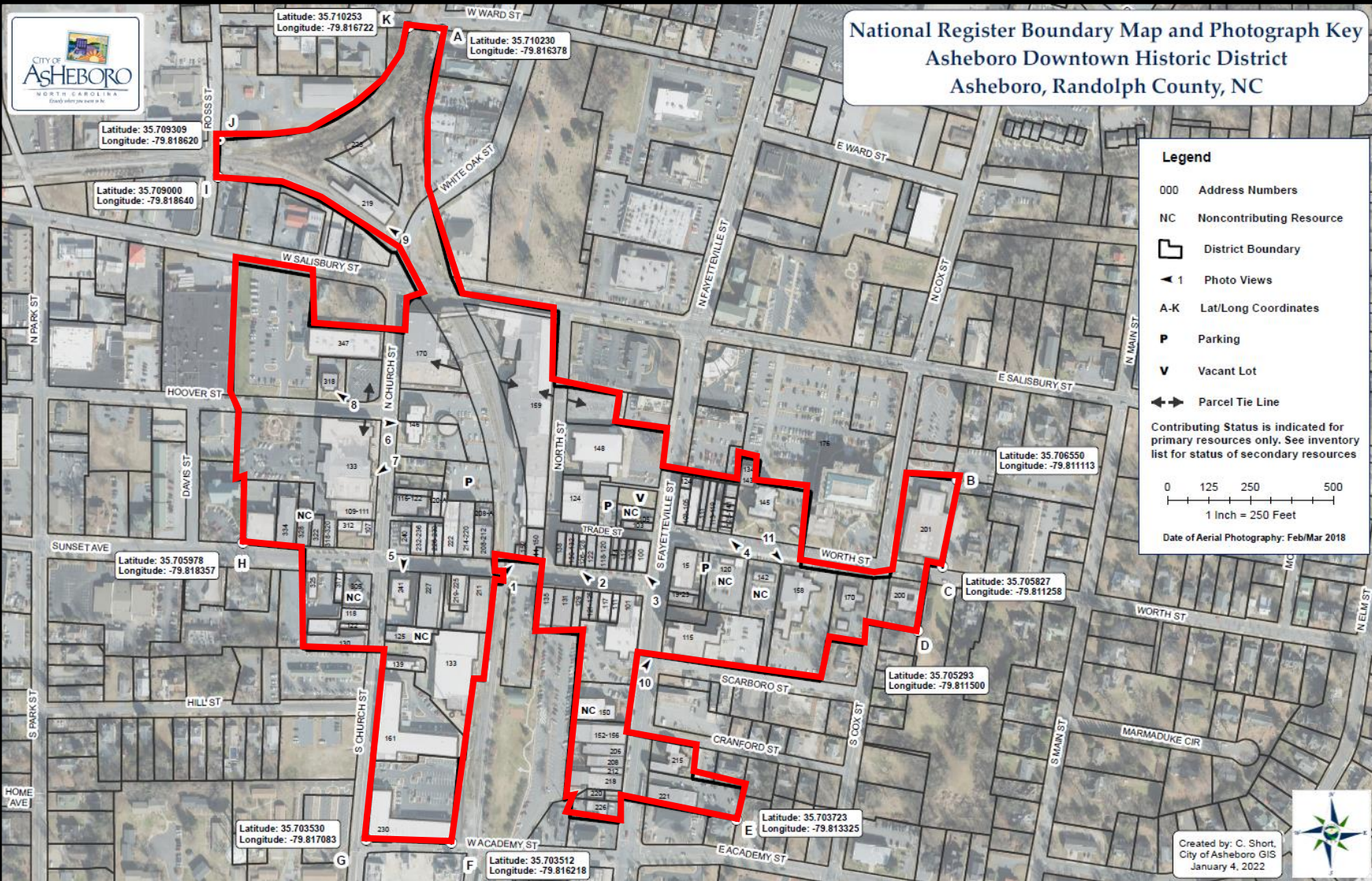

Created by: C. Short,  
 City of Asheboro GIS  
 January 4, 2022

# Jarrell Center City Garden



Jarrell  
Center  
City Garden

S MAIN ST

S COX ST

CRANFORD ST

S COX ST

SCARBORO ST

S COX ST

WORTH ST





Improve Fire Service -

Construct New Emergency Operations Center



*Asheboro Fire is now Asheboro Fire & Rescue Dept.*

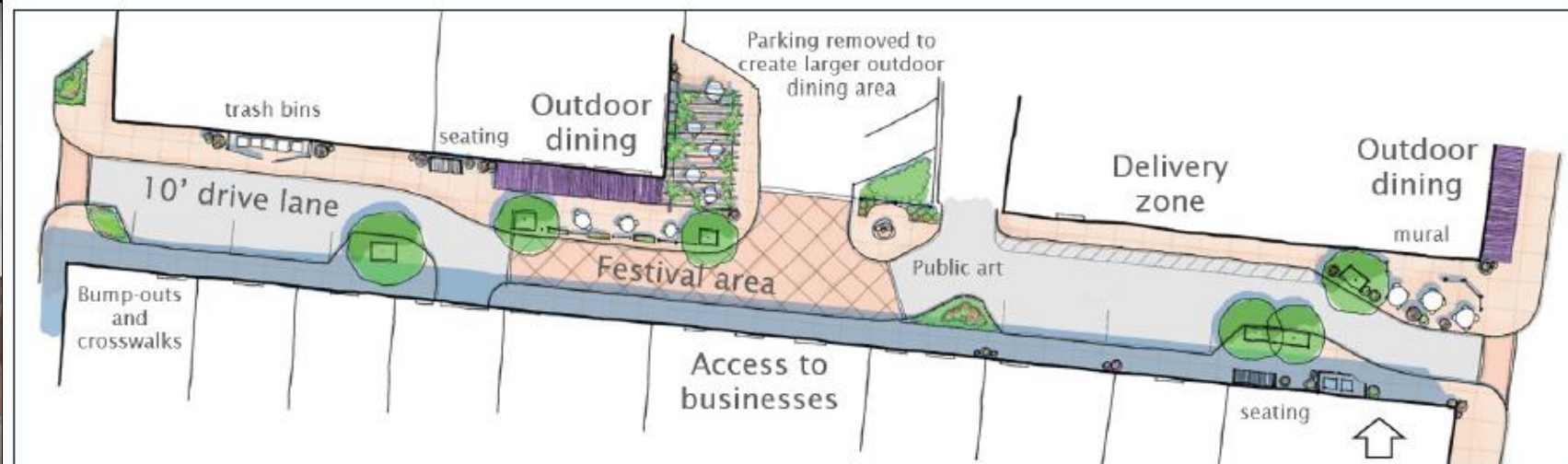

Trade St. Conceptual Plan



# Trade Street Improvements

# Diverse Housing Options

The city has approved new residential development in 2022 that could result in approximately 500 new housing units coming online in the next few years ... and more applications are anticipated.

An aerial photograph showing a residential development, 'Robin's Nest', situated in a heavily wooded area. The development consists of several clusters of single-family homes, each with its own driveway and parking space. The houses are arranged in a somewhat irregular pattern, following the contours of the land. The surrounding forest is dense and green, providing a natural backdrop for the development. The overall appearance is that of a traditional single-family neighborhood.

# Example of Traditional Single-Family

*Robin's Nest – 15 year buildout  
(approx. 100 homesites)*

**Thomas Estates –  
Old Cedar Falls Rd  
(approx. 140  
homesites)**

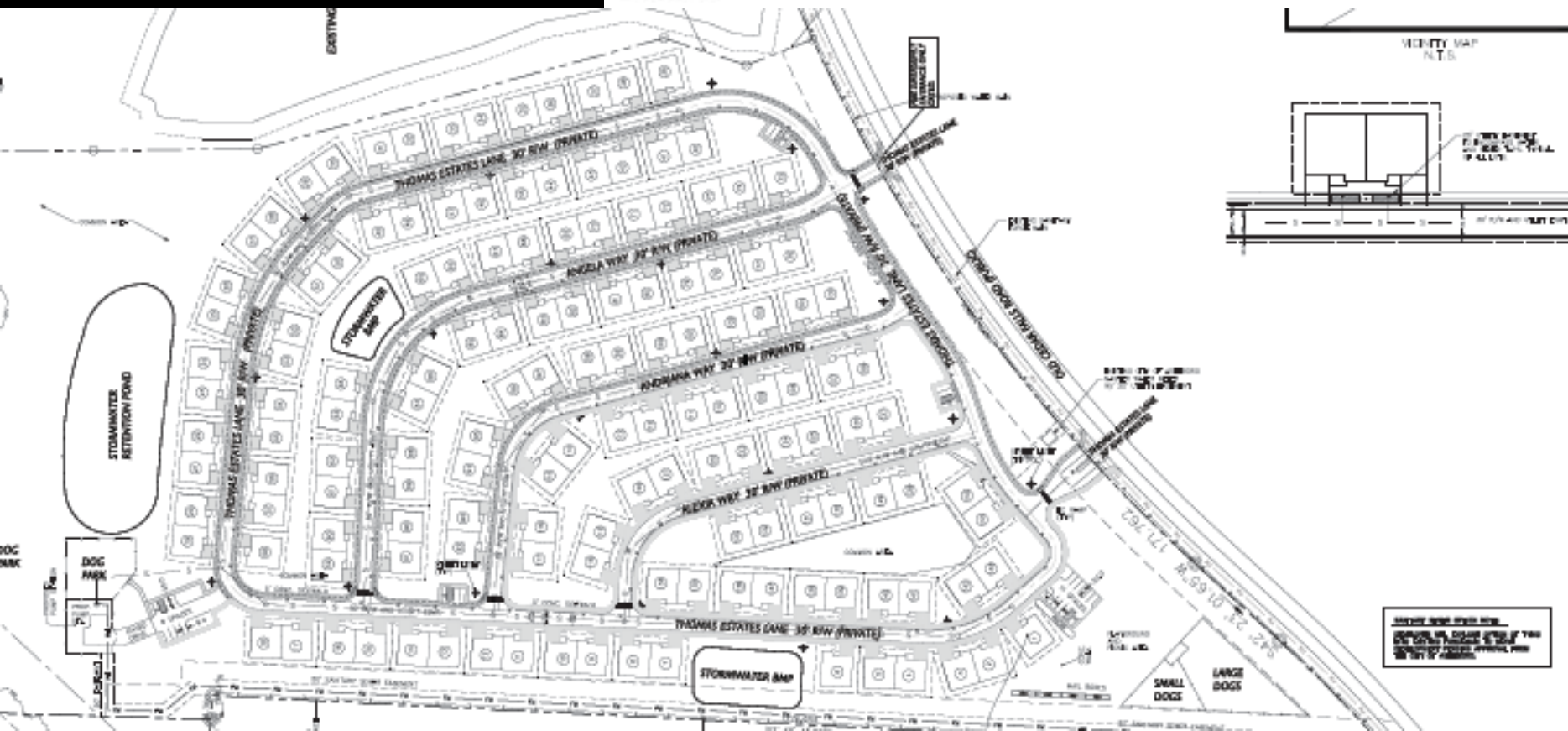

**Twin Homes**

An aerial photograph of a residential area with several streets highlighted in red. The streets are labeled with white text: WIKMETT ST, LANIER AVE, HAMMER AVE, and S CHURCH ST. The text is oriented vertically for the north-south streets and horizontally for the east-west streets. In the center of the map, there is yellow text that reads "Revitalization Memorial Square (50-60 senior apartments)". The map shows houses, trees, and a parking lot with several cars.

**Revitalization**  
*Memorial Square*  
*(50-60 senior apartments)*

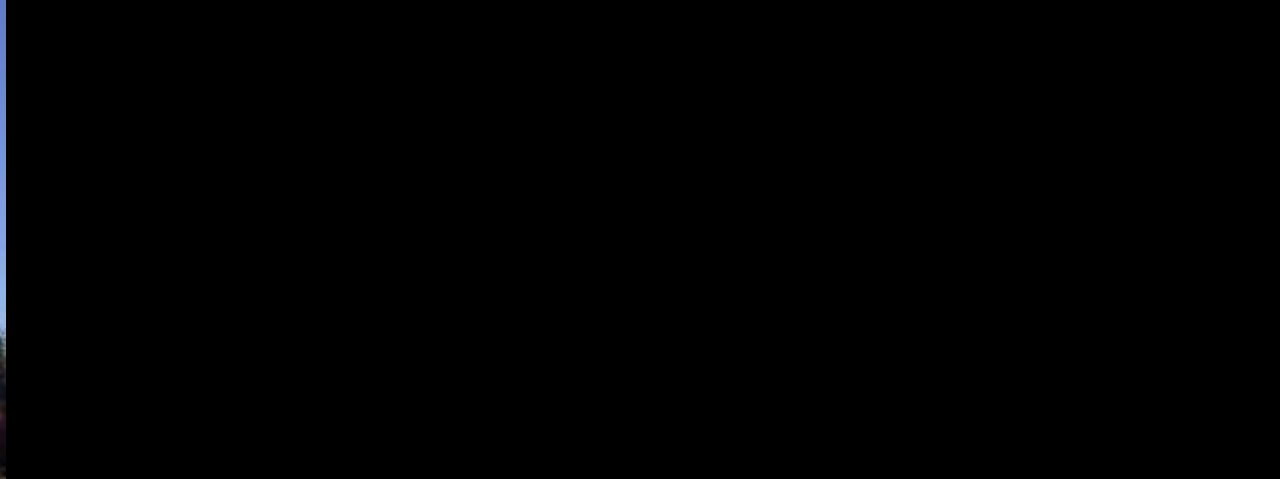



4 REAR ELEVATION  
330' x 110'



2 RIGHT SIDE ELEVATION  
330' x 110'

3 LEFT SIDE ELEVATION  
330' x 110'



STANDING SEAM METAL ROOF



*Church Street Lofts  
(50 senior apartments)*



**Senior Housing**



**Redevelopment  
Acme-McCrary Property  
Anticipated Market Rate Housing  
(+100 apartments)**

# Economic Development

City and County have supported several economic development projects leading to significant investment and job creation.

PEMMCO



FIBERTEX



TECHNIMARK



SEDIA



STARPET



# Regional Airport Upgrades



# Community Partners

The city is proud of its partnerships with governmental, business, and non-profit entities that improve Asheboro.

# QUALITY OF LIFE



# ECONOMIC DEVELOPMENT

# HOUSING

